

NPT Adapters

K0101— Male NPT x Male NPT

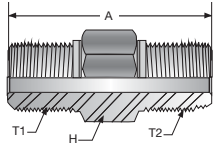

Part Number	T1 Thread Size	T2 Thread Size	A Overall Length		H Hex		Max. Working Pressure	
			inch	mm	inch	mm	psi	MPa
#								
10K0101-12-12C	3/4" - 14 NPT	3/4" - 14 NPT	2.44	61.98	1.13	28.70	10,000	69
10K0101-16-16C	1" - 11-1/2 NPT	1" - 11-1/2 NPT	2.75	69.85	1.38	35.05	10,000	69
15K0101-1-1C	1/16" - 27 NPT	1/16" - 27 NPT	1.00	25.40	0.38	9.65	15,000	103
15K0101-2-2C	1/8" - 27 NPT	1/8" - 27 NPT	1.20	30.48	0.50	12.70	15,000	103
15K0101-4-4C	1/4" - 18 NPT	1/4" - 18 NPT	1.44	36.58	0.63	16.00	15,000	103
15K0101-6-6C	3/8" - 18 NPT	3/8" - 18 NPT	1.70	43.18	0.75	19.05	15,000	103
15K0101-8-8C	1/2" - 14 NPT	1/2" - 14 NPT	2.25	57.15	1.00	25.40	15,000	103
15K0101-2-1C	1/8" - 27 NPT	1/16" - 27 NPT	1.13	28.70	0.50	12.70	15,000	103
15K0101-2-4C	1/8" - 27 NPT	1/4" - 18 NPT	1.35	34.29	0.625	15.88	15,000	103
15K0101-6-8C	3/8" - 18 NPT	1/2" - 14 NPT	1.85	46.99	1.00	25.40	15,000	103
15K0101-12-6C	3/4" - 14 NPT	3/8" - 18 NPT	1.95	49.53	1.125	28.58	15,000	103
15K0101-16-6C	1" - 11-1/2 NPT	3/8" - 18 NPT	2.16	54.86	1.375	34.93	15,000	103
10K0101-12-4C	3/4" - 14 NPT	1/4" - 18 NPT	2.03	51.56	1.125	28.58	10,000	69
10K0101-16-4C	1" - 11-1/2 NPT	1/4" - 18 NPT	2.16	54.86	1.375	34.93	10,000	69
10K0101-16-12C	1" - 11-1/2 NPT	3/4" - 14 NPT	2.56	65.02	1.375	34.93	10,000	69

NPT Adapters

K0201— Female NPT x Male NPT

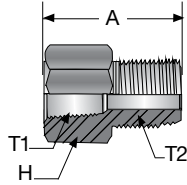

Part Number	T1 Thread Size	T2 Thread Size	A Overall Length		H Hex		Max. Working Pressure	
			inch	mm	inch	mm	psi	MPa
#								
15K0201-1-8C	1/16" - 27 NPT	1/2" - 14 NPT	1.25	31.75	0.87	22.10	15,000	103
15K0201-2-8C	1/8" - 27 NPT	1/2" - 14 NPT	1.25	31.75	0.87	22.10	15,000	103
15K0201-4-8C	1/4" - 18 NPT	1/2" - 14 NPT	1.25	31.75	0.87	22.10	15,000	103
15K0201-6-8C	3/8" - 18 NPT	1/2" - 14 NPT	1.63	41.40	1.00	25.40	15,000	103
15K0201-1-4C	1/16" - 27 NPT	1/4" - 18 NPT	1.30	33.02	0.625	15.88	15,000	103
15K0201-2-1C	1/8" - 27 NPT	1/16" - 27 NPT	1.38	35.05	0.75	19.05	15,000	103
15K0201-4-1C	1/4" - 18 NPT	3/4" - 14 NPT	1.56	39.62	0.875	22.23	15,000	103
15K0201-4-6C	1/4" - 18 NPT	3/8" - 18 NPT	1.50	38.10	0.87	22.10	15,000	103
15K0201-6-2C	3/8" - 18 NPT	1/8" - 27 NPT	1.58	40.13	1.00	25.40	15,000	103
15K0201-6-6C	3/8" - 18 NPT	3/8" - 18 NPT	1.78	45.21	1.00	25.40	15,000	103
15K0201-8-8C	1/2" - 14 NP	1/2" - 14 NPT	2.13	54.10	1.25	31.75	15,000	103
10K0201-4-12C	1/4" - 18 NPT	3/4" - 14 NPT	1.63	41.40	1.125	28.58	10,000	69
10K0201-6-12C	3/8" - 18 NPT	3/4" - 14 NPT	1.60	40.64	1.125	28.58	10,000	69
10K0201-6-16C	3/8" - 18 NPT	1" - 11-1/2 NPT	1.90	48.26	1.375	34.93	10,000	69
10K0201-12-6C	3/4" - 14 NPT	3/8" - 18 NPT	2.25	57.15	1.50	38.10	10,000	69
10K0201-12-12C	3/4" - 14 NPT	3/4" - 14 NPT	2.25	57.15	1.50	38.10	10,000	69
10K0201-12-16C	3/4" - 14 NPT	1" - 11-1/2 NPT	2.25	57.15	1.50	38.10	10,000	69
10K0201-16-6C	1" - 11-1/2 NPT	3/8" - 18 NPT	2.35	59.69	2.00	50.80	10,000	69
10K0201-16-8C	1" - 11-1/2 NPT	1/2" - 14 NPT	2.50	63.50	2.00	50.80	10,000	69

NPT Adapters

K0202— Female NPT x Female NPT

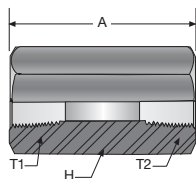

Part Number	T1 Thread Size	T2 Thread Size	A Overall Length		H Hex		Max. Working Pressure	
			inch	mm	inch	mm	psi	MPa
#								
15K0202-2-2C	1/8" - 27 NPT	1/8" - 27 NPT	1.50	38.10	0.75	19.05	15,000	103
15K0202-4-1C	1/4" - 18 NPT	1/16" - 27 NPT	1.63	41.40	0.875	22.23	15,000	103
15K0202-4-4C	1/4" - 18 NPT	1/4" - 18 NPT	1.75	44.45	0.87	22.10	15,000	103
15K0202-6-2C	3/8" - 18 NPT	1/8" - 27 NPT	1.75	44.45	1.00	25.40	15,000	103
15K0202-6-6C	3/8" - 18 NPT	3/8" - 18 NPT	1.75	44.45	1.00	25.40	15,000	103
15K0202-8-1C	1/2" - 14 NPT	1/16" - 27 NPT	1.75	44.45	1.25	31.75	15,000	103
15K0202-8-2C	1/2" - 14 NPT	1/8" - 27 NPT	1.75	44.45	1.25	31.75	15,000	103
15K0202-8-6C	1/2" - 14 NPT	3/8" - 18 NPT	1.75	44.45	1.25	31.75	15,000	103
15K0202-8-8C	1/2" - 14 NPT	1/2" - 14 NPT	2.13	54.10	1.25	31.75	15,000	103
10K0202-12-4C	3/4" - 14 NPT	1/4" - 18 NPT	2.00	50.80	1.50	38.10	10,000	69
10K0202-12-6C	3/4" - 14 NPT	3/8" - 18 NPT	2.00	50.80	1.50	38.10	10,000	69
10K0202-12-12C	3/4" - 14 NPT	3/4" - 14 NPT	2.13	54.10	1.50	38.10	10,000	69
10K0202-12-16C	3/4" - 14 NPT	1" - 11-1/2 NPT	2.38	60.45	2.00	50.80	10,000	69
10K0202-16-16C	1" - 11-1/2 NPT	1" - 11-1/2 NPT	2.50	63.50	2.00	50.80	10,000	69

YA02 — Male Type “M” x Female NPT

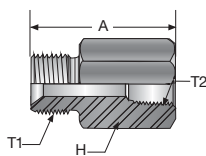

Part Number	T1 Thread Size	T2 Thread Size	A Overall Length		H Hex		Max. Working Pressure	
			inch	mm	inch	mm	psi	MPa
#								
YA02-6-4C	9/16" - 18 UNF	1/4" - 18 NPT	1.50	38.10	0.75	19.05	15,000	103
YA02-6-8C	9/16" - 18 UNF	1/2" - 14 NPT	2.00	50.80	1.25	31.75	15,000	103
YA02-6-16C	9/16" - 18 UNF	1" - 11-1/2 NPT	2.38	60.45	2.00	50.80	10,000	69
YA02-8-4C	3/4" - 16 UNF	1/4" - 18 NPT	1.63	41.40	0.875	22.23	15,000	103
YA02-8-6C	3/4" - 16 UNF	3/8" - 18 NPT	1.75	44.45	1.00	25.40	15,000	103
YA02-8-8C	3/4" - 16 UNF	1/2" - 14 NPT	2.00	50.80	1.25	31.75	15,000	103
YA02-8-12C	3/4" - 16 UNF	3/4" - 14 NPT	2.13	54.10	1.5	38.10	10,000	69
YA02-11-8C	1" - 12 UNF	1/2" - 14 NPT	2.50	63.50	1.00	25.40	15,000	103
YA02-11-12C	1" - 12 UNF	3/4" - 14 NPT	2.13	54.10	1.50	38.10	10,000	69
YA02-16-16C	1-5/16" - 12 UNF	1" - 11-1/2 NPT	2.38	60.45	2.00	50.80	10,000	69

NPT Adapters

YA01 — Male Type “M” x Male NPT

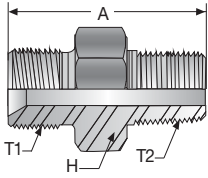

Part Number	T1 Thread Size	T2 Thread Size	A Overall Length		H Hex		Max. Working Pressure	
			inch	mm	inch	mm	psi	MPa
#								
YA01-6-2C	9/16" - 18 UNF	1/8" - 27 NPT	1.28	32.51	0.63	16.00	15,000	103
YA01-6-4C	9/16" - 18 UNF	1/4" - 18 NPT	1.38	35.05	0.63	16.00	15,000	103
YA01-6-6C	9/16" - 18 UNF	3/8" - 18 NPT	1.57	39.88	0.75	19.05	15,000	103
YA01-6-8C	9/16" - 18 UNF	1/2" - 14 NPT	1.75	44.45	0.88	22.35	15,000	103
YA01-6-12C	9/16" - 18 UNF	3/4" - 14 NPT	1.95	49.53	1.13	28.58	10,000	69
YA01-6-16C	9/16" - 18 UNF	1" - 11-1/2 NPT	2.26	57.40	1.38	34.93	10,000	69
YA01-8-4C	3/4" - 16 UNF	1/4" - 18 NPT	1.8	45.72	0.75	19.05	15,000	103
YA01-8-6C	3/4" - 16 UNF	3/8" - 18 NPT	1.73	43.94	0.75	19.05	15,000	103
YA01-8-8C	3/4" - 16 UNF	1/2" - 14 NPT	1.95	49.53	0.88	22.35	15,000	103
YA01-8-12C	3/4" - 16 UNF	3/4" - 14 NPT	2.13	54.10	1.13	28.70	10,000	69
YA01-8-16C	3/4" - 16 UNF	1" - 11-1/2 NPT	2.38	60.45	1.38	35.05	10,000	69
YA01-11-6C	1" - 12 UNF	3/8" - 18 NPT	1.85	46.99	1.00	25.40	15,000	103
YA01-11-8C	1" - 12 UNF	1/2" - 14 NPT	2.00	50.80	1.00	25.40	15,000	103
YA01-11-12C	1" - 12 UNF	3/4" - 14 NPT	2.13	54.10	1.13	28.70	10,000	69
YA01-11-16C	1" - 12 UNF	1" - 11-1/2 NPT	2.38	60.45	1.38	35.05	10,000	69
YA01-16-8C	1-5/16" - 12 UNF	1/2" - 14 NPT	2.13	54.10	1.38	35.05	15,000	103
YA01-16-12C	1-5/16" - 12 UNF	3/4" - 14 NPT	2.38	60.45	1.38	35.05	10,000	69
YA01-16-16C	1-5/16" - 12 UNF	1" - 11-1/2 NPT	2.5	63.50	1.38	35.05	10,000	69
YA01-16-20C	1-5/16" - 12 UNF	1-1/4" - 11-1/2 NPT	2.75	69.85	1.75	44.45	10,000	69
YA01-16-24C	1-5/16" - 12 UNF	1-1/2" - 11-1/2 NPT	2.75	69.85	2.00	50.80	7,500	52
YA01-16-32C	1-5/16" - 12 UNF	2" - 11-1/2 NPT	2.75	69.85	2.38	60.45	7,500	52

NPT Adapters

5Y01 — Female Medium Pressure x Male NPT

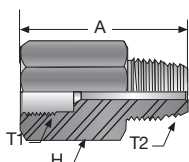

Part Number	T1 Thread Size	T2 Thread Size	A Overall Length		H Hex		Max. Working Pressure	
			inch	mm	inch	mm	psi	MPa
#								
5Y01-4-2C	7/16" - 20 UNF	1/8" - 27 NPT	1.43	36.32	0.75	19.05	15,000	103
5Y01-4-4C	7/16" - 20 UNF	1/4" - 18 NPT	1.62	41.15	0.75	19.05	15,000	103
5Y01-4-6C	7/16" - 20 UNF	3/8" - 18 NPT	1.62	41.15	0.75	19.05	15,000	103
5Y01-4-8C	7/16" - 20 UNF	1/2" - 14 NPT	1.75	44.45	1.00	25.40	15,000	103
5Y01-4-12C	7/16" - 20 UNF	3/4" - 14 NPT	1.87	47.50	1.37	34.80	10,000	69
5Y01-4-16C*	7/16" - 20 UNF	1" - 11-1/2 NPT	1.87	47.50	1.37	34.80	10,000	69
5Y01-6-2C*	9/16" - 18 UNF	1/8" - 27 NPT	1.43	36.32	0.75	19.05	15,000	103
5Y01-6-4C	9/16" - 18 UNF	1/4" - 18 NPT	1.62	41.15	0.75	19.05	15,000	103
5Y01-6-6C	9/16" - 18 UNF	3/8" - 18 NPT	1.62	41.15	0.75	19.05	15,000	103
5Y01-6-8C	9/16" - 18 UNF	1/2" - 14 NPT	1.74	44.20	1.00	25.40	15,000	103
5Y01-6-12C	9/16" - 18 UNF	3/4" - 14 NPT	1.87	47.50	1.37	34.80	10,000	69
5Y01-6-16C	9/16" - 18 UNF	1" - 11-1/2 NPT	1.87	47.50	1.37	34.80	10,000	69
5Y01-9-2C*	13/16" - 16 UNF	1/8" - 27 NPT	1.87	47.50	1.00	25.40	15,000	103
5Y01-9-4C	13/16" - 16 UNF	1/4" - 18 NPT	1.87	47.50	1.00	25.40	15,000	103
5Y01-9-6C	13/16" - 16 UNF	3/8" - 18 NPT	1.87	47.50	1.00	25.40	15,000	103
5Y01-9-8C	13/16" - 16 UNF	1/2" - 14 NPT	1.87	47.50	1.00	25.40	15,000	103
5Y01-9-12C	13/16" - 16 UNF	3/4" - 14 NPT	1.87	47.50	1.37	34.80	10,000	69
5Y01-9-16C	13/16" - 16 UNF	1" - 11-1/2 NPT	1.87	47.50	1.37	34.80	10,000	69
5Y01-12-2C*	3/4" - 14 NPS	1/8" - 27 NPT	2.50	63.50	1.37	34.80	15,000	103
5Y01-12-4C	3/4" - 14 NPS	1/4" - 18 NPT	2.50	63.50	1.37	34.80	15,000	103
5Y01-12-6C*	3/4" - 14 NPS	3/8" - 18 NPT	2.50	63.50	1.37	34.80	15,000	103
5Y01-12-8C	3/4" - 14 NPS	1/2" - 14 NPT	2.50	63.50	1.37	34.80	15,000	103
5Y01-12-12C	3/4" - 14 NPS	3/4" - 14 NPT	2.50	63.50	1.37	34.80	15,000	103
5Y01-12-16C	3/4" - 14 NPS	1" - 11-1/2 NPT	2.50	63.50	1.37	34.80	15,000	103
5Y01-16-2C*	1-3/8" - 12 UNF	1/8" - 27 NPT	2.50	63.50	1.37	34.80	15,000	103
5Y01-16-4C	1-3/8" - 12 UNF	1/4" - 18 NPT	2.50	63.50	1.37	34.80	15,000	103
5Y01-16-6C*	1-3/8" - 12 UNF	3/8" - 18 NPT	2.50	63.50	1.37	34.80	15,000	103
5Y01-16-8C	1-3/8" - 12 UNF	1/2" - 14 NPT	2.50	63.50	1.37	34.80	15,000	103
5Y01-16-12C	1-3/8" - 12 UNF	3/4" - 14 NPT	2.50	63.50	1.37	34.80	15,000	103
5Y01-16-16C	1-3/8" - 12 UNF	1" - 11-1/2 NPT	2.50	63.50	1.37	34.80	10,000	69

*Non-standard part - may require longer lead time

NPT Adapters

02Y5 — Female NPT x Male Medium Pressure

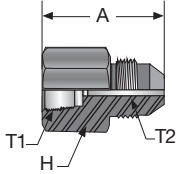

Part Number	T1 Thread Size	T2 Thread Size	A Overall Length		H Hex		Max. Working Pressure	
			inch	mm	inch	mm	psi	MPa
#								
02Y5-1-9C	1/16" - 27 NPT	13/16" - 16 UNF	2.00	50.80	1.12	28.45	15,000	103
02Y5-2-4C	1/8" - 27 NPT	7/16" - 20 UNF	1.75	44.45	0.75	19.05	15,000	103
02Y5-2-6C	1/8" - 27 NPT	9/16" - 18 UNF	1.87	47.50	0.75	19.05	15,000	103
02Y5-2-9C	1/8" - 27 NPT	13/16" - 16 UNF	1.87	47.50	0.87	22.10	15,000	103
02Y5-2-12C	1/8" - 27 NPT	3/4" - 14 NPSM	2.00	50.80	1.12	28.45	15,000	103
02Y5-2-16C*	1/8" - 27 NPT	1" - 14 UNF LH	3.00	76.20	1.00	25.40	15,000	103
02Y5-4-4C	1/4" - 18 NPT	7/16" - 20 UNF	1.75	44.45	0.75	19.05	15,000	103
02Y5-4-6C	1/4" - 18 NPT	9/16" - 18 UNF	1.87	47.50	0.75	19.05	15,000	103
02Y5-4-9C	1/4" - 18 NPT	13/16" - 16 UNF	1.87	47.50	0.87	22.10	15,000	103
02Y5-4-12C	1/4" - 18 NPT	3/4" - 14 NPSM	2.00	50.80	1.12	28.45	15,000	103
02Y5-4-16C	1/4" - 18 NPT	1" - 14 UNF LH	3.00	76.20	1.00	25.40	15,000	103
02Y5-6-4C	3/8" - 18 NPT	7/16" - 20 UNF	2.00	50.80	1.00	25.40	15,000	103
02Y5-6-6C	3/8" - 18 NPT	9/16" - 18 UNF	2.12	53.85	1.00	25.40	15,000	103
02Y5-6-9C	3/8" - 18 NPT	13/16" - 16 UNF	2.25	57.15	1.00	25.40	15,000	103
02Y5-6-12C	3/8" - 18 NPT	3/4" - 14 NPSM	2.00	50.80	1.12	28.45	15,000	103
02Y5-6-16C	3/8" - 18 NPT	1" - 14 UNF LH	3.00	76.20	1.00	25.40	15,000	103
02Y5-8-4C	1/2" - 14 NPT	7/16" - 20 UNF	2.12	53.85	1.12	28.45	15,000	103
02Y5-8-6C	1/2" - 14 NPT	9/16" - 18 UNF	1.25	31.75	1.12	28.45	15,000	103
02Y5-8-9C	1/2" - 14 NPT	13/16" - 16 UNF	2.37	60.20	1.12	28.45	15,000	103
02Y5-8-12C	1/2" - 14 NPT	3/4" - 14 NPSM	2.50	63.50	1.12	28.45	15,000	103
02Y5-8-16C	1/2" - 14 NPT	1" - 14 UNF LH	3.75	95.25	1.12	28.45	15,000	103
02Y5-12-4C*	3/4" - 14 NPT	7/16" - 20 UNF	2.37	60.20	1.37	34.80	10,000	69
02Y5-12-6C	3/4" - 14 NPT	9/16" - 18 UNF	2.50	63.50	1.37	34.80	10,000	69
02Y5-12-9C	3/4" - 14 NPT	13/16" - 16 UNF	2.62	66.55	1.37	34.80	10,000	69
02Y5-12-12C	3/4" - 14 NPT	3/4" - 14 NPSM	2.75	69.85	1.50	38.10	10,000	69
02Y5-12-16C	3/4" - 14 NPT	1" - 14 UNF LH	4.12	104.65	1.50	38.10	10,000	69
02Y5-16-6C	1-3/8" - 12 UNF	9/16" - 18 UNF	2.87	72.90	1.87	47.50	10,000	69
02Y5-16-9C	1-3/8" - 12 UNF	13/16" - 16 UNF	3.00	76.20	1.87	47.50	10,000	69
02Y5-16-12C	1-3/8" - 12 UNF	3/4" - 14 NPSM	3.00	76.20	1.87	47.50	10,000	69
02Y5-16-16C	1-3/8" - 12 UNF	1" - 14 UNF LH	4.37	111.00	1.87	47.50	10,000	69

*Non-standard part - may require longer lead time

NPT Adapters

Y501 — Male Medium Pressure x Male NPT

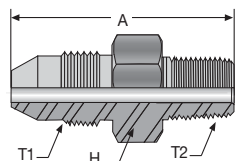

Part Number	T1 Thread Size	T2 Thread Size	A Overall Length		H Hex		Max. Working Pressure	
			inch	mm	inch	mm	psi	MPa
#								
Y501-4-4C	7/16" - 20 UNF	1/4" - 18 NPT	1.60	40.64	0.63	16.00	15,000	103
Y501-4-8C	7/16" - 20 UNF	1/2" - 14 NPT	2.12	53.85	0.87	22.10	15,000	103
Y501-6-4C	9/16" - 18 UNF	1/4" - 18 NPT	2.06	52.32	0.75	19.05	15,000	103
Y501-6-6C	9/16" - 18 UNF	3/8" - 18 NPT	2.06	52.32	0.75	19.05	15,000	103
Y501-6-8C	9/16" - 18 UNF	1/2" - 14 NPT	2.18	55.37	0.87	22.10	15,000	103
Y501-9-2C*	13/16" - 16 UNF	1/8" - 27 NPT	2.12	53.85	0.87	22.10	15,000	103
Y501-9-4C	13/16" - 16 UNF	1/4" - 18 NPT	2.25	57.15	0.87	22.10	15,000	103
Y501-9-6C	13/16" - 16 UNF	3/8" - 18 NPT	2.25	57.15	0.87	22.10	15,000	103
Y501-9-8C	13/16" - 16 UNF	1/2" - 14 NPT	2.37	60.20	0.87	22.10	15,000	103
Y501-9-12C	13/16" - 16 UNF	3/4" - 14 NPT	2.62	66.55	1.12	28.45	10,000	69
Y501-9-16C	13/16" - 16 UNF	1" - 11-1/2 NPT	2.62	66.55	1.37	34.80	10,000	69
Y501-12-2C*	3/4" - 14 NPS	1/8" - 27 NPT	2.37	60.20	1.12	28.45	15,000	103
Y501-12-4C*	3/4" - 14 NPS	1/4" - 18 NPT	2.50	63.50	1.12	28.45	15,000	103
Y501-12-6C*	3/4" - 14 NPS	3/8" - 18 NPT	2.50	63.50	1.12	28.45	15,000	103
Y501-12-8C	3/4" - 14 NPS	1/2" - 14 NPT	2.62	66.55	1.12	28.45	15,000	103
Y501-12-12C	3/4" - 14 NPS	3/4" - 14 NPT	2.75	69.85	1.12	28.45	10,000	69
Y501-12-16C	3/4" - 14 NPS	1" - 11-1/2 NPT	3.00	76.20	1.37	34.80	10,000	69
Y501-16-2C*	1-3/8" - 12 UNF	1/8" - 27 NPT	3.62	91.95	1.00	25.40	15,000	103
Y501-16-4C	1-3/8" - 12 UNF	1/4" - 18 NPT	3.75	95.25v	1.00	25.40	15,000	103
Y501-16-6C	1-3/8" - 12 UNF	3/8" - 18 NPT	3.75	95.25	1.00	25.40	15,000	103
Y501-16-8C	1-3/8" - 12 UNF	1/2" - 14 NPT	3.87	98.30	1.00	25.40	15,000	103
Y501-16-12C	1-3/8" - 12 UNF	3/4" - 14 NPT	3.87	98.30	1.12	28.45	10,000	69
Y501-16-16C	1-3/8" - 12 UNF	1" - 11-1/2 NPT	4.00	101.60	1.37	34.80	10,000	69

*Non-standard part - may require longer lead time

NPT Adapters

5Y02 — Female Medium Pressure x Female NPT Coupling

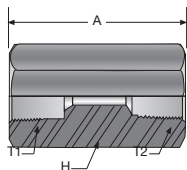

Part Number	T1 Thread Size	T2 Thread Size	A Overall Length		H Hex		Max. Working Pressure	
			inch	mm	inch	mm	psi	MPa
#								
5Y02-4-2C	7/16" - 20 UNF	1/8" - 27 NPT	1.62	41.15	0.75	19.05	15,000	103
5Y02-4-4C	7/16" - 20 UNF	1/4" - 18 NPT	1.62	41.15	0.75	19.05	15,000	103
5Y02-4-6C	7/16" - 20 UNF	3/8" - 18 NPT	2.00	50.80	1.00	25.40	15,000	103
5Y02-4-8C	7/16" - 20 UNF	1/2" - 14 NPT	2.00	50.80	1.12	28.45	15,000	103
5Y02-4-12C*	7/16" - 20 UNF	3/4" - 14 NPT	2.37	60.20	1.37	34.80	10,000	69
5Y02-4-16C*	7/16" - 20 UNF	1" - 11-1/2 NPT	2.62	66.55	2.00	50.80	10,000	69
5Y02-6-2C	9/16" - 18 UNF	1/8" - 27 NPT	1.75	44.45	0.75	19.05	15,000	103
5Y02-6-4C	9/16" - 18 UNF	1/4" - 18 NPT	1.75	44.45	0.75	19.05	15,000	103
5Y02-6-6C	9/16" - 18 UNF	3/8" - 18 NPT	2.12	53.85	1.00	25.40	15,000	103
5Y02-6-8C	9/16" - 18 UNF	1/2" - 14 NPT	2.12	53.85	1.12	28.45	15,000	103
5Y02-6-12C	9/16" - 18 UNF	3/4" - 14 NPT	2.37	60.20	1.37	34.80	10,000	69
5Y02-6-16C*	9/16" - 18 UNF	1" - 11-1/2 NPT	2.75	69.85	2.00	50.80	10,000	69
5Y02-9-2C*	13/16" - 16 UNF	1/8" - 27 NPT	2.12	53.85	1.00	25.40	15,000	103
5Y02-9-4C	13/16" - 16 UNF	1/4" - 18 NPT	2.12	53.85	1.00	25.40	15,000	103
5Y02-9-6C	13/16" - 16 UNF	3/8" - 18 NPT	2.12	53.85	1.00	25.40	15,000	103
5Y02-9-8C	13/16" - 16 UNF	1/2" - 14 NPT	2.25	57.15	1.12	28.45	15,000	103
5Y02-9-12C	13/16" - 16 UNF	3/4" - 14 NPT	2.50	63.50	1.37	34.80	10,000	69
5Y02-9-16C*	13/16" - 16 UNF	1" - 11-1/2 NPT	2.87	72.90	2.00	50.80	10,000	69
5Y02-12-2C*	3/4" - 14 NPS	1/8" - 27 NPT	2.50	63.50	1.37	34.80	15,000	103
5Y02-12-4C*	3/4" - 14 NPS	1/4" - 18 NPT	2.50	63.50	1.37	34.80	15,000	103
5Y02-12-6C*	3/4" - 14 NPS	3/8" - 18 NPT	2.50	63.50	1.37	34.80	15,000	103
5Y02-12-8C	3/4" - 14 NPS	1/2" - 14 NPT	2.50	63.50	1.37	34.80	15,000	103
5Y02-12-12C	3/4" - 14 NPS	3/4" - 14 NPT	2.75	69.85	1.50	38.10	10,000	69
5Y02-12-16C	3/4" - 14 NPS	1" - 11-1/2 NPT	3.00	76.20	1.87	47.50	15,000	103
5Y02-16-2C*	1-3/8" - 12 UNF	1/8" - 27 NPT	3.00	76.20	1.75	44.45	15,000	103
5Y02-16-4C*	1-3/8" - 12 UNF	1/4" - 18 NPT	3.00	76.20	1.75	44.45	15,000	103
5Y02-16-6C*	1-3/8" - 12 UNF	3/8" - 18 NPT	3.00	76.20	1.75	44.45	15,000	103
5Y02-16-8C*	1-3/8" - 12 UNF	1/2" - 14 NPT	3.00	76.20	1.75	44.45	15,000	103
5Y02-16-12C	1-3/8" - 12 UNF	3/4" - 14 NPT	3.50	88.90	1.50	38.10	10,000	69
5Y02-16-16C	1-3/8" - 12 UNF	1" - 11-1/2 NPT	3.75	95.25	1.87	47.50	10,000	69

*Non-standard part - may require longer lead time

NPT Adapters

6Y02 — Female High Pressure x Female NPT Coupling

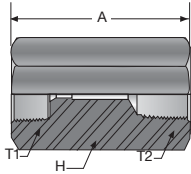

Part Number	T1 Thread Size	T2 Thread Size	A Overall Length		H Hex		Max. Working Pressure	
			inch	mm	inch	mm	psi	MPa
#								
6Y02-4-2C*	9/16" - 18 UNF	1/8" - 27 NPT	1.50	38.10	1.00	25.40	15,000	103
6Y02-4-4C	9/16" - 18 UNF	1/4" - 18 NPT	1.50	38.10	1.00	25.40	15,000	103
6Y02-4-6C	9/16" - 18 UNF	3/8" - 18 NPT	1.87	47.50	1.00	25.40	15,000	103
6Y02-4-8C	9/16" - 18 UNF	1/2" - 14 NPT	1.87	47.50	1.12	28.45	15,000	103
6Y02-4-12C	9/16" - 18 UNF	3/4" - 14 NPT	2.00	50.80	1.62	41.15	10,000	69
6Y02-4-16C*	9/16" - 18 UNF	1" - 11-1/2 NPT	2.50	63.50	1.75	44.45	10,000	69
6Y02-6-2C	3/4" - 16 UNF	1/8" - 27 NPT	1.87	47.50	1.00	25.40	15,000	103
6Y02-6-4C	3/4" - 16 UNF	1/4" - 18 NPT	1.87	47.50	1.00	25.40	15,000	103
6Y02-6-6C	3/4" - 16 UNF	3/8" - 18 NPT	1.87	47.50	1.00	25.40	15,000	103
6Y02-6-8C	3/4" - 16 UNF	1/2" - 14 NPT	1.87	47.50	1.12	28.45	15,000	103
6Y02-6-12C	3/4" - 16 UNF	3/4" - 14 NPT	2.12	53.85	1.37	34.80	10,000	69
6Y02-6-16C*	3/4" - 16 UNF	1" - 11-1/2 NPT	2.50	63.50	1.75	44.45	10,000	69
6Y02-9-2C	1-1/8" - 12 UNF	1/8" - 27 NPT	2.37	60.20	1.37	34.80	15,000	103
6Y02-9-4C	1-1/8" - 12 UNF	1/4" - 18 NPT	2.37	60.20	1.37	34.80	15,000	103
6Y02-9-6C	1-1/8" - 12 UNF	3/8" - 18 NPT	2.37	60.20	1.37	34.80	15,000	103
6Y02-9-8C	1-1/8" - 12 UNF	1/2" - 14 NPT	2.37	60.20	1.37	34.80	15,000	103
6Y02-9-12C	1-1/8" - 12 UNF	3/4" - 14 NPT	2.37	60.20	1.37	34.80	10,000	69
6Y02-9-16C*	1-1/8" - 12 UNF	1" - 11-1/2 NPT	2.62	66.55	2.00	50.80	10,000	69

*Non-standard part - may require longer lead time

NPT Adapters

6Y01 — Female High Pressure x Male NPT

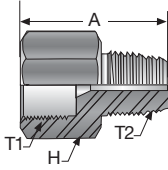

Part Number	T1 Thread Size	T2 Thread Size	A Overall Length		H Hex		Max. Working Pressure	
			inch	mm	inch	mm	psi	MPa
#								
6Y01-4-2C	9/16" - 18 UNF	1/8" - 27 NPT	1.25	31.75	0.75	19.05	15,000	103
6Y01-4-4C	9/16" - 18 UNF	1/4" - 18 NPT	1.37	34.80	0.75	19.05	15,000	103
6Y01-4-6C	9/16" - 18 UNF	3/8" - 18 NPT	1.37	34.80	0.75	19.05	15,000	103
6Y01-4-8C	9/16" - 18 UNF	1/2" - 14 NPT	1.75	44.45	1.00	25.40	15,000	103
6Y01-4-12C	9/16" - 18 UNF	3/4" - 14 NPT	1.75	44.45	1.37	34.80	10,000	69
6Y01-4-16C	9/16" - 18 UNF	1" - 11-1/2 NPT	1.62	41.15	1.37	34.80	10,000	69
6Y01-6-1C	3/4" - 16 UNF	1/16" - 27 NPT	1.63	41.40	1.00	25.40	15,000	103
6Y01-6-2C*	3/4" - 16 UNF	1/8" - 27 NPT	1.50	38.10	1.00	25.40	15,000	103
6Y01-6-4C	3/4" - 16 UNF	1/4" - 18 NPT	1.62	41.15	1.00	25.40	15,000	103
6Y01-6-6C	3/4" - 16 UNF	3/8" - 18 NPT	1.62	41.15	1.00	25.40	15,000	103
6Y01-6-8C	3/4" - 16 UNF	1/2" - 14 NPT	1.75	44.45	1.00	25.40	15,000	103
6Y01-6-12C*	3/4" - 16 UNF	3/4" - 14 NPT	1.87	47.50	1.37	34.80	10,000	69
6Y01-6-16C	3/4" - 16 UNF	1" - 11-1/2 NPT	1.87	47.50	1.37	34.80	10,000	69
6Y01-9-2C*	1-1/8" - 12 UNF	1/8" - 27 NPT	1.50	38.10	1.37	34.80	15,000	103
6Y01-9-4C	1-1/8" - 12 UNF	1/4" - 18 NPT	1.62	41.15	1.27	32.26	15,000	103
6Y01-9-6C	1-1/8" - 12 UNF	3/8" - 18 NPT	1.75	44.45	1.37	34.80	15,000	103
6Y01-9-8C	1-1/8" - 12 UNF	1/2" - 14 NPT	1.87	47.50	1.37	34.80	15,000	103
6Y01-9-12C	1-1/8" - 12 UNF	3/4" - 14 NPT	1.87	47.50	1.37	34.80	10,000	69
6Y01-9-16C	1-1/8" - 12 UNF	1" - 11-1/2 NPT	2.00	50.80	1.37	34.80	10,000	69

*Non-standard part - may require longer lead time

NPT Adapters

Y601 — Male High Pressure x Male NPT

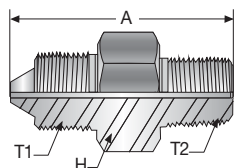

Part Number	T1 Thread Size	T2 Thread Size	A Overall Length		H Hex		Max. Working Pressure	
			inch	mm	inch	mm	psi	MPa
#								
Y601-4-2C	9/16" - 18 UNF	1/8" - 27 NPT	1.87	47.50	0.62	15.75	15,000	103
Y601-4-4C	9/16" - 18 UNF	1/4" - 18 NPT	2.06	52.32	0.75	19.05	15,000	103
Y601-4-6C	9/16" - 18 UNF	3/8" - 18 NPT	2.00	50.80	0.75	19.05	15,000	103
Y601-4-8C	9/16" - 18 UNF	1/2" - 14 NPT	2.12	53.85	0.87	22.10	15,000	103
Y601-4-12C	9/16" - 18 UNF	3/4" - 14 NPT	2.25	57.15	1.12	28.45	10,000	69
Y601-6-4C	3/4" - 16 UNF	1/4" - 18 NPT	2.12	53.85	0.87	22.10	15,000	103
Y601-6-6C	3/4" - 16 UNF	3/8" - 18 NPT	2.12	53.85	0.87	22.10	15,000	103
Y601-6-8C	3/4" - 16 UNF	1/2" - 14 NPT	2.28	57.91	0.875	22.23	15,000	103
Y601-9-4C	1-1/8" - 12 UNF	1/4" - 18 NPT	2.37	60.20	1.12	28.45	15,000	103
Y601-9-6C	1-1/8" - 12 UNF	3/8" - 18 NPT	2.37	60.20	1.12	28.45	15,000	103
Y601-9-8C	1-1/8" - 12 UNF	1/2" - 14 NPT	2.50	63.50	1.12	28.45	15,000	103
Y601-9-12C	1-1/8" - 12 UNF	3/4" - 14 NPT	2.62	66.55	1.12	28.45	10,000	69
Y601-9-16C	1-1/8" - 12 UNF	1" - 11-1/2 NPT	2.75	69.85	1.37	34.80	10,000	69

02Y6 — Female NPT x Male High Pressure

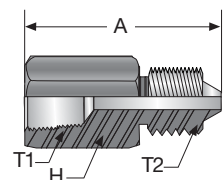

Part Number	T1 Thread Size	T2 Thread Size	A Overall Length		H Hex		Max. Working Pressure	
			inch	mm	inch	mm	psi	MPa
#								
02Y6-1-6C	1/16" - 27 NPT	3/4" - 16 UNF	1.75	44.45	0.75	19.05	15,000	103
02Y6-2-4C	1/8" - 27 NPT	9/16" - 18 UNF	1.62	41.15	0.75	19.05	15,000	103
02Y6-2-6C	1/8" - 27 NPT	3/4" - 16 UNF	1.62	41.15	0.75	19.05	15,000	103
02Y6-2-9C	1/8" - 27 NPT	1-1/8" - 12 UNF	2.12	53.85	1.12	28.45	15,000	103
02Y6-4-4C	1/4" - 18 NPT	9/16" - 18 UNF	1.75	44.45	0.75	19.05	15,000	103
02Y6-4-6C	1/4" - 18 NPT	3/4" - 16 UNF	1.75	44.45	0.75	19.05	15,000	103
02Y6-4-9C	1/4" - 18 NPT	1-1/8" - 12 UNF	2.12	53.85	1.12	28.45	15,000	103
02Y6-6-4C	3/8" - 18 NPT	9/16" - 18 UNF	1.75	44.45	1.00	25.40	15,000	103
02Y6-6-6C	3/8" - 18 NPT	3/4" - 16 UNF	1.75	44.45	1.00	25.40	15,000	103
02Y6-6-9C	3/8" - 18 NPT	1-1/8" - 12 UNF	2.12	53.85	1.12	28.45	15,000	103
02Y6-8-4C	1/2" - 14 NPT	9/16" - 18 UNF	2.12	53.85	1.12	28.45	15,000	103
02Y6-8-6C	1/2" - 14 NPT	3/4" - 16 UNF	2.12	53.85	1.12	28.45	15,000	103
02Y6-8-9C	1/2" - 14 NPT	1-1/8" - 12 UNF	2.12	53.85	1.12	28.45	15,000	103
02Y6-12-6C	3/4" - 14 NPT	3/4" - 16 UNF	1.50	38.10	1.62	41.15	10,000	69
02Y6-12-9C	3/4" - 14 NPT	1-1/8" - 12 UNF	2.25	57.15	1.37	34.80	10,000	69
02Y6-16-9C	1" - 11-1/2 NPT	1-1/8" - 12 UNF	2.00	50.80	2.75	69.85	10,000	69

NPT Adapters

K0203— Female NPT x Male JIC

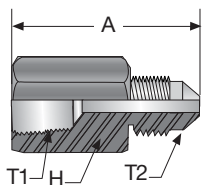

Part Number	T1 Thread Size	T2 Thread Size	A Overall Length		H Hex		Max. Working Pressure	
			inch	mm	inch	mm	psi	MPa
#								
10K0203-4-6C	1/4" - 18 NPT	9/16" - 18 UNF	1.68	42.67	0.875	22.23	10,000	69
10K0203-4-8C	1/4" - 18 NPT	3/4" - 16 UNF	1.79	45.47	0.875	22.23	10,000	69
10K0203-6-4C	3/8" - 18 NPT	7/16" - 20 UNF	1.76	44.70	1.00	25.40	10,000	69
10K0203-6-6C	3/8" - 18 NPT	9/16" - 18 UNF	1.68	42.67	1.00	25.40	10,000	69
10K0203-6-8C	3/8" - 18 NPT	3/4" - 16 UNF	1.88	47.75	1.00	25.40	10,000	69
10K0203-8-4C	1/2" - 14 NPT	7/16" - 20 UNF	2.05	52.07	1.25	31.75	10,000	69
10K0203-8-6C	1/2" - 14 NPT	9/16" - 18 UNF	1.93	49.02	1.25	31.75	10,000	69
10K0203-8-8C	1/2" - 14 NPT	3/4" - 16 UNF	2.04	51.82	1.25	31.75	10,000	69
10K0203-16-16C	1" - 11-1/2 NPT	1-5/16" - 12 UNF	2.68	68.07	2.00	50.80	10,000	69

01D9 — Male NPT x Male BSP

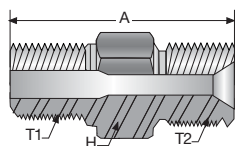

Part Number	T1 Thread Size	T2 Thread Size	A Overall Length		H Hex		Max. Working Pressure	
			inch	mm	inch	mm	psi	MPa
#								
01D9-6-6C	3/8" - 18 NPT	G3/8 - 19	1.57	39.88	0.875	22.23	15,000	103
01D9-8-6C	1/2" - 14 NPT	G3/8 - 19	1.86	47.24	0.875	22.23	15,000	103
01D9-8-8C	1/2" - 14 NPT	G1/2 - 14	1.98	50.29	1.000	25.40	15,000	103

02D9 — Female NPT x Male BSP

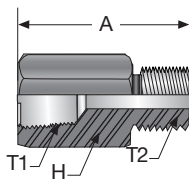



Part Number	T1 Thread Size	T2 Thread Size	A Overall Length		H Hex		Max. Working Pressure	
			inch	mm	inch	mm	psi	MPa
#								
02D9-8-8C	1/2" - 14 NPT	G1/2 - 14	2.10	53.34	1.25	31.75	15,000	103

NPT Adapters

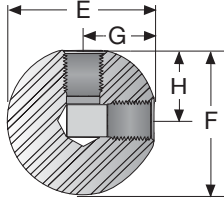

KL02 — NPT Elbow

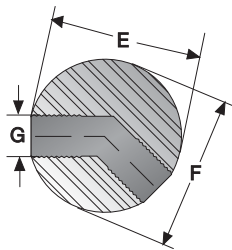

Part Number	Thread Size	Thickness	E		F		G		H		Max. Working Pressure	
			inch	mm	inch	mm	inch	mm	inch	mm	psi	MPa
#												
10KL02-12C	3/4" - 14 NPT	2.05	1.85	46.99	1.85	46.99	1.35	34.29	1.35	34.29	10,000	69
10KL02-16C	1" - 11-1/2 NPT	2.5	3.83	97.28	3.83	97.28	1.82	46.23	1.82	46.23	10,000	69
15KL02-4C	1/4" - 18 NPT	1.15	1.7	43.18	1.7	43.18	0.8	20.32	0.8	20.32	15,000	103
15KL02-6C	3/8" - 18 NPT	1.38	1.9	48.26	1.9	48.26	0.9	22.86	0.9	22.86	15,000	103
15KL02-8C	1/2" - 14 NPT	1.63	2.15	54.61	2.15	54.61	1.03	26.16	1.03	26.16	15,000	103

KL02 — NPT 45° Elbow

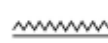

Part Number	Thread Size	Thickness	E		F		G		Max. Working Pressure	
			inch	mm	inch	mm	inch	mm	psi	MPa
#										
15KL02-4C-45	1/4" - 18 NPT	1.15	1.68	42.67	1.68	42.67	0.7	17.78	15,000	103
15KL02-6C-45	3/8" - 18 NPT	1.38	1.89	48.01	1.89	48.01	0.91	23.11	15,000	103
15KL02-8C-45	1/2" - 14 NPT	1.63	2.15	54.61	2.15	54.61	0.94	23.88	15,000	103
15KL02-12C-45	3/4" - 14 NPT	2	2.88	73.15	2.88	73.15	1.2	30.48	10,000	69

NPT Adapters

KT02 — NPT Tee

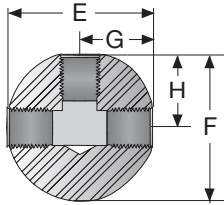

Part Number	Thread Size	Thickness	E		F		G		H		Max. Working Pressure	
			inch	mm	inch	mm	inch	mm	inch	mm	psi	MPa
#												
10KT02-12C	3/4" - 14 NPT	2.05	2.70	68.58	1.85	46.99	1.35	34.29	2.05	52.07	10,000	69
10KT02-16C	1" - 11-1/2 NPT	2.50	3.63	92.20	3.83	97.28	1.82	46.23	2.5	63.50	10,000	69
15KT02-4C	1/4" - 18 NPT	1.15	1.60	40.64	1.7	43.18	0.8	20.32	1.15	29.21	15,000	103
15KT02-6C	3/8" - 18 NPT	1.38	1.80	45.72	1.9	48.26	0.9	22.86	1.38	35.05	15,000	103
15KT02-8C	1/2" - 14 NPT	1.63	2.05	52.07	2.15	54.61	1.03	26.16	1.63	41.40	15,000	103

KX02 — NPT Cross

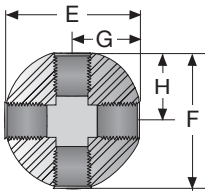



Part Number	Thread Size	Thickness	E		F		G		H		Max. Working Pressure	
			inch	mm	inch	mm	inch	mm	inch	mm	psi	MPa
#												
10KX02-12C	3/4" - 14 NPT	2.05	2.70	68.58	2.7	68.58	1.35	34.29	1.35	34.29	10,000	69
10KX02-16C	1" - 11-1/2 NPT	2.50	3.63	92.20	3.63	92.20	1.82	46.23	1.82	46.23	10,000	69
15KX02-4C	1/4" - 18 NPT	1.15	1.60	40.64	1.6	40.64	0.8	20.32	0.8	20.32	15,000	103
15KX02-6C	3/8" - 18 NPT	1.38	1.80	45.72	1.8	45.72	0.9	22.86	0.9	22.86	15,000	103
15KX02-8C	1/2" - 14 NPT	1.63	2.05	52.07	2.05	52.07	1.03	26.16	1.03	26.16	15,000	103

NPT Adapters

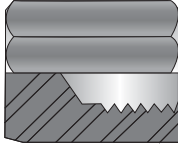

NPT Caps

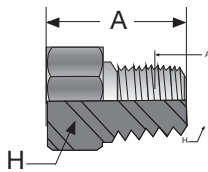

Part Number	Thread Size	Overall Length		Hex		Max. Working Pressure	
		inch	mm	inch	mm	psi	MPa
#							
15K02-2C-CAP	1/8" - 27 NPT	0.90	22.86	0.75	19.05	15,000	103
15K02-4C-CAP	1/4" - 18 NPT	1.16	29.46	0.875	22.23	15,000	103
15K02-6C-CAP	3/8" - 18 NPT	1.25	31.75	1.00	25.40	15,000	103
15K02-8C-CAP	1/2" - 14 NPT	1.43	36.32	1.25	31.75	15,000	103
15K02-12C-CAP	3/4" - 14 NPT	1.5	38.10	1.50	38.10	15,000	103

NPT Plugs



Part Number	Thread Size	A Overall Length		Hex		Max. Working Pressure	
		inch	mm	inch	mm	psi	MPa
#							
10KP01-12C	3/4" - 14 NPT	1.45	36.83	1.125	28.58	10,000	69
10KP01-16C	1" - 11-1/2 NPT	1.81	45.97	1.375	34.93	10,000	69
15KP01-1C	1/16" - 27 NPT	0.68	17.27	0.375	9.53	15,000	103
15KP01-2C	1/8" - 27 NPT	0.75	19.05	0.50	12.70	15,000	103