

Ordering Information and Dimensions (Tubing Connection, 2-Way)

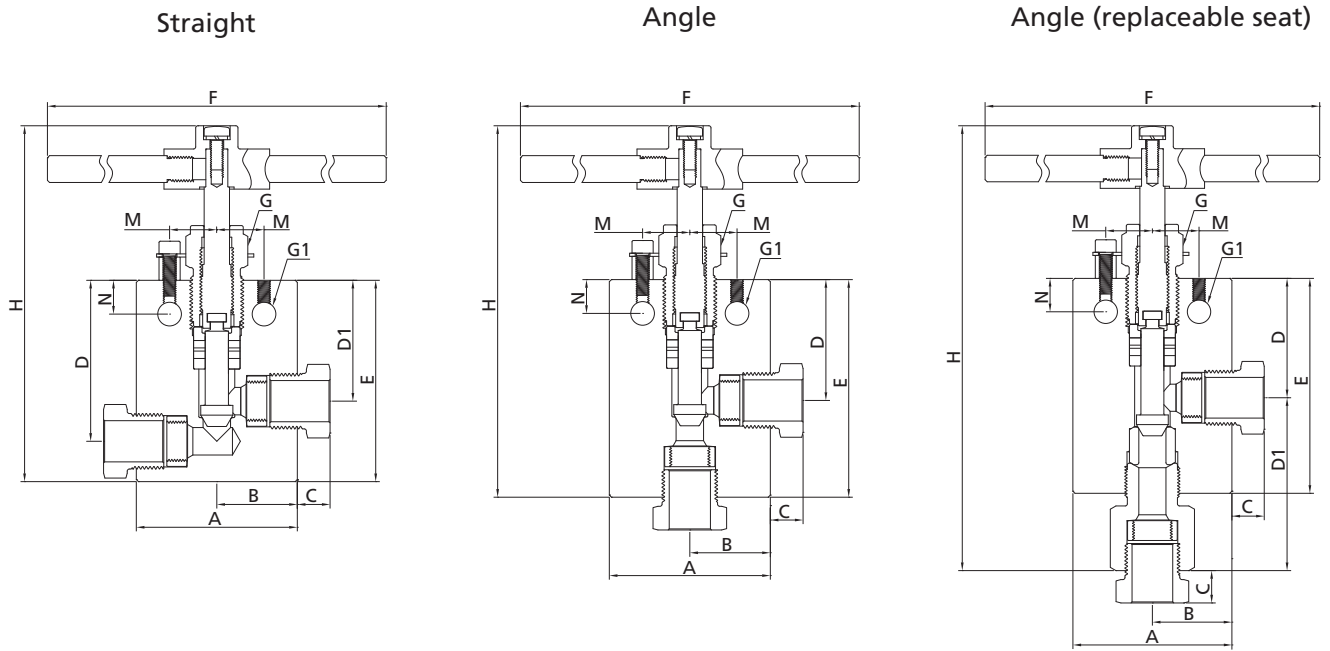

Straight															
Ordering Number	Connection	Orifice in. (mm)	Dimensions, in. (mm)												
			A	B	C	D	D1	E	F	G	G1	H	M	N	Thickness
10NSS-2FH9-1	2FH9	0.359 (9.12)	2.50 (63.5)	1.25 (31.8)	0.55 (14.0)	2.38 (60.5)	1.75 (44.5)	2.88 (73.2)	4.00 (101.6)	1.00 (25.4)	0.34 (8.6)	6.20 (157.4)	0.69 (17.5)	0.50 (12.7)	1.00 (25.4)
10NSS-2FH12-1	2FH12	0.516 (13.11)	3.00 (76.2)	1.50 (38.1)	0.60 (15.2)	3.00 (76.2)	2.25 (57.2)	3.75 (95.3)	10.25 (260.4)	1.19 (30.2)	0.44 (11.2)	7.24 (183.8)	0.88 (22.4)	0.63 (16.0)	1.38 (35.1)
10NSS-2FH16-1	2FH16	0.688 (17.48)	4.12 (104.7)	2.06 (52.3)	0.74 (18.7)	3.75 (95.3)	2.81 (71.4)	4.63 (117.6)	10.25 (260.4)	1.62 (41.2)	0.56 (14.2)	9.33 (237.1)	1.25 (31.8)	1.13 (28.7)	1.75 (44.5)

Angle															
Ordering Number	Connection	Orifice in. (mm)	Dimensions, in. (mm)												
			A	B	C	D	D1	E	F	G	G1	H	M	N	Thickness
10NSS-2FH9-2	2FH9	0.359 (9.12)	2.50 (63.5)	1.25 (31.8)	0.55 (14.0)	1.75 (44.5)	/	3.38 (85.9)	4.00 (101.6)	1.00 (25.4)	0.34 (8.6)	6.70 (170.3)	0.69 (17.5)	0.50 (12.7)	1.00 (25.4)
10NSS-2FH12-2	2FH12	0.516 (13.11)	3.00 (76.2)	1.50 (38.1)	0.60 (15.2)	2.25 (57.2)	/	4.25 (107.9)	10.25 (260.4)	1.19 (30.2)	0.44 (11.2)	7.73 (196.4)	0.88 (22.4)	0.63 (16.0)	1.38 (35.1)
10NSS-2FH16-2	2FH16	0.688 (17.48)	4.12 (104.7)	2.06 (52.3)	0.74 (18.7)	2.81 (71.4)	/	5.12 (130.1)	10.25 (260.4)	1.62 (41.2)	0.56 (14.2)	9.83 (249.7)	1.25 (31.8)	1.13 (28.7)	1.75 (44.5)

Angle (replaceable seat)															
Ordering Number	Connection	Orifice in. (mm)	Dimensions, in. (mm)												
			A	B	C	D	D1	E	F	G	G1	H	M	N	Thickness
10NSS-2FH9-3	2FH9	0.359 (9.12)	2.50 (63.5)	1.25 (31.8)	0.55 (14.0)	1.75 (44.5)	2.50 (63.5)	3.38 (85.9)	4.00 (101.6)	1.00 (25.4)	0.34 (8.6)	7.57 (192.4)	0.69 (17.5)	0.50 (12.7)	1.00 (25.4)
10NSS-2FH12-3	2FH12	0.516 (13.11)	3.00 (76.2)	1.50 (38.1)	0.60 (15.2)	2.25 (57.2)	3.19 (81.1)	4.25 (107.9)	10.25 (260.4)	1.19 (30.2)	0.44 (11.2)	8.92 (226.8)	0.88 (22.4)	0.63 (16.0)	1.38 (35.1)
10NSS-2FH16-3	2FH16	0.688 (17.48)	4.12 (104.7)	2.06 (52.3)	0.74 (18.7)	2.81 (71.4)	4.11 (104.5)	5.25 (133.3)	10.25 (260.4)	1.62 (41.2)	0.56 (14.2)	11.62 (295.4)	1.25 (31.8)	1.13 (28.7)	1.75 (44.5)

Medium & High Pressure Fittings and Tubing
Quick Couplings
Medium & High Pressure Valves
Line Filters
Sour Service Products
Subsea Valves
Tools and Installation Instructions
Technical Information

Ordering Information and Dimensions (Tubing Connection, 3-Way)

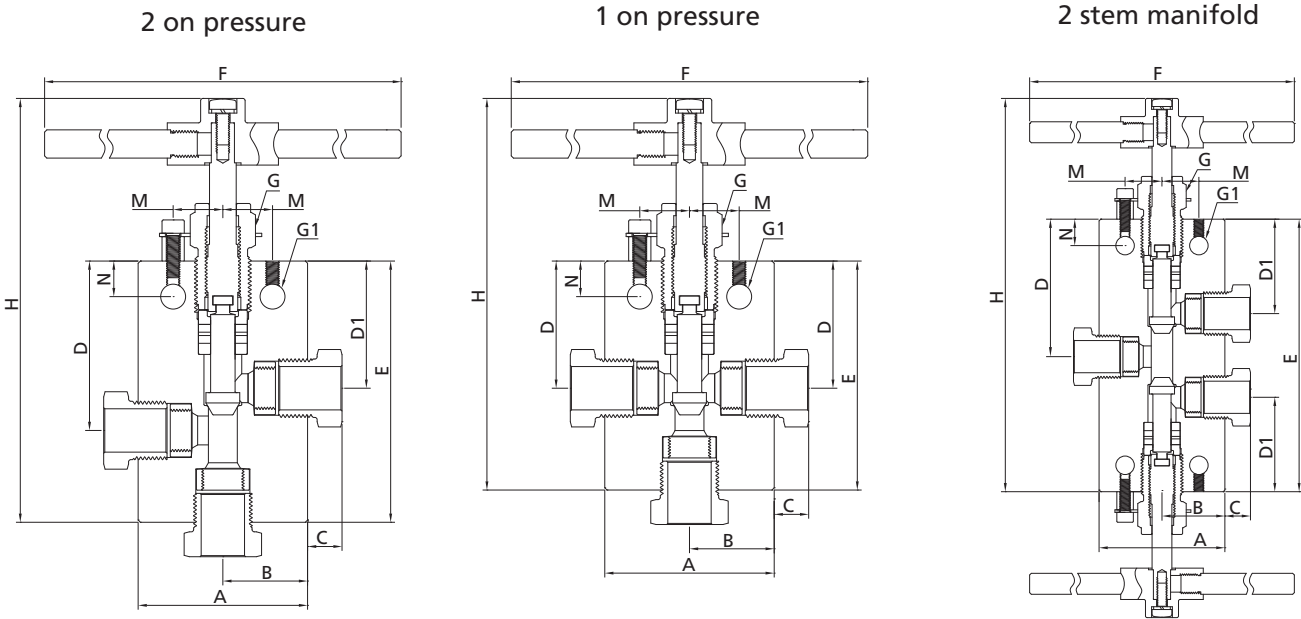

2 on pressure															
Ordering Number	Connection	Orifice in. (mm)	Dimensions, in. (mm)												
			A	B	C	D	D1	E	F	G	G1	H	M	N	Thickness
10NSS-2FH9-4	2FH9	0.359 (9.12)	2.50 (63.5)	1.25 (31.8)	0.55 (14.0)	2.38 (60.5)	1.75 (44.5)	3.63 (92.1)	4.00 (101.6)	1.00 (25.4)	0.34 (8.6)	6.95 (176.5)	0.69 (17.5)	0.50 (12.7)	1.00 (25.4)
10NSS-2FH12-4	2FH12	0.516 (13.11)	3.00 (76.2)	1.50 (38.1)	0.60 (15.2)	3.00 (76.2)	2.25 (57.2)	4.63 (117.5)	10.25 (260.4)	1.19 (30.2)	0.44 (11.2)	8.11 (206.0)	0.88 (22.4)	0.63 (16.0)	1.38 (35.1)
10NSS-2FH16-4	2FH16	0.688 (17.48)	4.12 (104.7)	2.06 (52.3)	0.74 (18.7)	3.75 (95.3)	2.81 (71.4)	5.88 (149.4)	10.25 (260.4)	1.62 (41.2)	0.56 (14.2)	10.58 (268.7)	1.25 (31.8)	1.13 (28.7)	1.75 (44.5)

1 on pressure															
Ordering Number	Connection	Orifice in. (mm)	Dimensions, in. (mm)												
			A	B	C	D	D1	E	F	G	G1	H	M	N	Thickness
10NSS-2FH9-5	2FH9	0.359 (9.12)	2.50 (63.5)	1.25 (31.8)	0.55 (14.0)	1.75 (44.5)	/	3.38 (85.9)	4.00 (101.6)	1.00 (25.4)	0.34 (8.6)	6.70 (170.3)	0.69 (17.5)	0.50 (12.7)	1.00 (25.4)
10NSS-2FH12-5	2FH12	0.516 (13.11)	3.00 (76.2)	1.50 (38.1)	0.60 (15.2)	2.25 (57.2)	/	4.25 (107.9)	10.25 (260.4)	1.19 (30.2)	0.44 (11.2)	7.73 (196.4)	0.88 (22.4)	0.63 (16.0)	1.38 (35.1)
10NSS-2FH16-5	2FH16	0.688 (17.48)	4.12 (104.7)	2.06 (52.3)	0.74 (18.7)	2.81 (71.4)	/	5.12 (130.1)	10.25 (260.4)	1.62 (41.2)	0.56 (14.2)	9.83 (249.7)	1.25 (31.8)	1.13 (28.7)	1.75 (44.5)

2 stem manifold															
Ordering Number	Connection	Orifice in. (mm)	Dimensions, in. (mm)												
			A	B	C	D	D1	E	F	G	G1	H	M	N	Thickness
10NSS-2FH9-6	2FH9	0.359 (9.12)	2.50 (63.5)	1.25 (31.8)	0.55 (14.0)	2.56 (65.1)	1.75 (44.5)	5.13 (130.2)	4.00 (101.6)	1.00 (25.4)	0.34 (8.6)	8.45 (214.6)	0.69 (17.5)	0.50 (12.7)	1.00 (25.4)
10NSS-2FH12-6	2FH12	0.516 (13.11)	3.00 (76.2)	1.50 (38.1)	0.60 (15.2)	3.25 (82.6)	2.25 (57.2)	6.50 (165.1)	10.25 (260.4)	1.19 (30.2)	0.44 (11.2)	9.98 (253.5)	0.88 (22.4)	0.63 (16.0)	1.38 (35.1)
10NSS-2FH16-6	2FH16	0.688 (17.48)	4.12 (104.7)	2.06 (52.3)	0.74 (18.7)	3.75 (95.3)	2.81 (71.4)	7.50 (190.5)	10.25 (260.4)	1.62 (41.2)	0.56 (14.2)	12.20 (310.1)	1.25 (31.8)	1.13 (28.7)	1.75 (44.5)

Medium & High Pressure Fittings and Tubing

Quick Couplings

Medium & High Pressure Valves

Line Filters

Sour Service Products

Subsea Valves

Tools and Installation Instructions

Technical Information

Ordering Information and Dimensions (Pipe Connection, 2-Way)

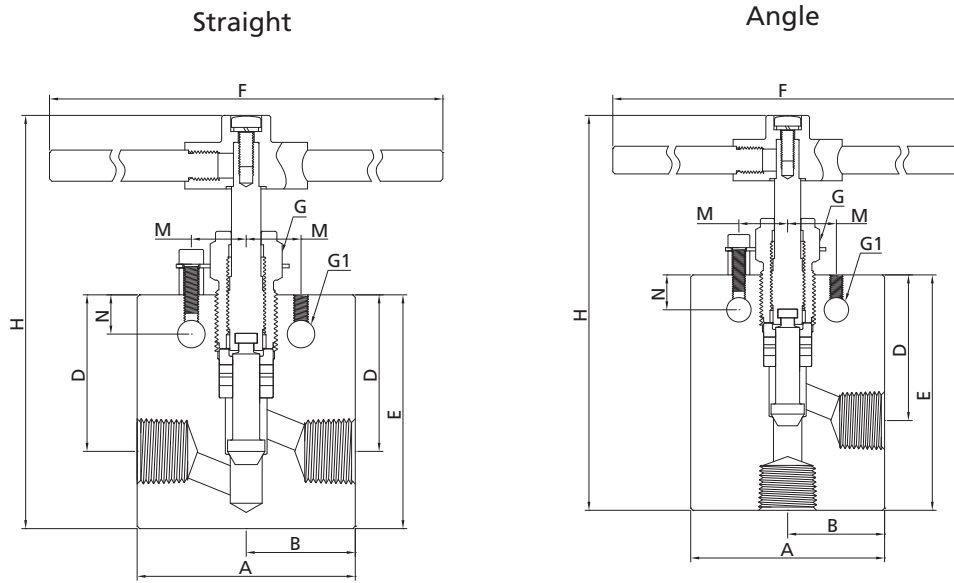

Straight															
Ordering Number	Connection	Orifice in. (mm)	Dimensions, in. (mm)												
			A	B	C	D	D1	E	F	G	G1	H	M	N	Thickness
10NSS-FNS12-1	FNS12	0.437 (11.10)	3.50 (88.9)	1.75 (44.5)	/	2.63 (66.8)	/	3.75	10.25	1.19	0.44	7.42	0.88	0.63	1.75
10NSS-FRT12-1	FRT12							(95.3)	(260.4)	(30.2)	(11.2)	(188.6)	(22.4)	(16.0)	(44.5)
10NSS-FNS16-1	FNS16	0.562 (14.27)	4.12 (104.7)	2.06 (52.3)	/	3.31 (84.1)	/	4.62	10.25	1.62	0.56	9.45	1.25	1.13	1.75
10NSS-FRT16-1	FRT16							(117.4)	(260.4)	(41.2)	(14.2)	(240.1)	(31.8)	(28.7)	(44.5)

Angle															
Ordering Number	Connection	Orifice in. (mm)	Dimensions, in. (mm)												
			A	B	C	D	D1	E	F	G	G1	H	M	N	Thickness
10NSS-FNS12-2	FNS12	0.437 (11.10)	3.50 (88.9)	1.75 (44.5)	/	2.63 (66.8)	/	4.25	10.25	1.19	0.44	7.92	0.88	0.63	1.75
10NSS-FRT12-2	FRT12							(107.9)	(260.4)	(30.2)	(11.2)	(201.3)	(22.4)	(16.0)	(44.5)
10NSS-FNS16-2	FNS16	0.562 (14.27)	4.12 (104.7)	2.06 (52.3)	/	3.31 (84.1)	/	5.12	10.25	1.64	0.56	9.94	1.25	1.13	1.75
10NSS-FRT16-2	FRT16							(130.1)	(260.4)	(41.2)	(14.2)	(252.5)	(31.8)	(28.7)	(44.5)

Medium & High Pressure Fittings and Tubing

Quick Couplings

Medium & High Pressure Valves

Line Filters

Sour Service Products

Subsea Valves

Tools and Installation Instructions

Technical Information

Ordering Information and Dimensions (Pipe Connection, 3-Way)

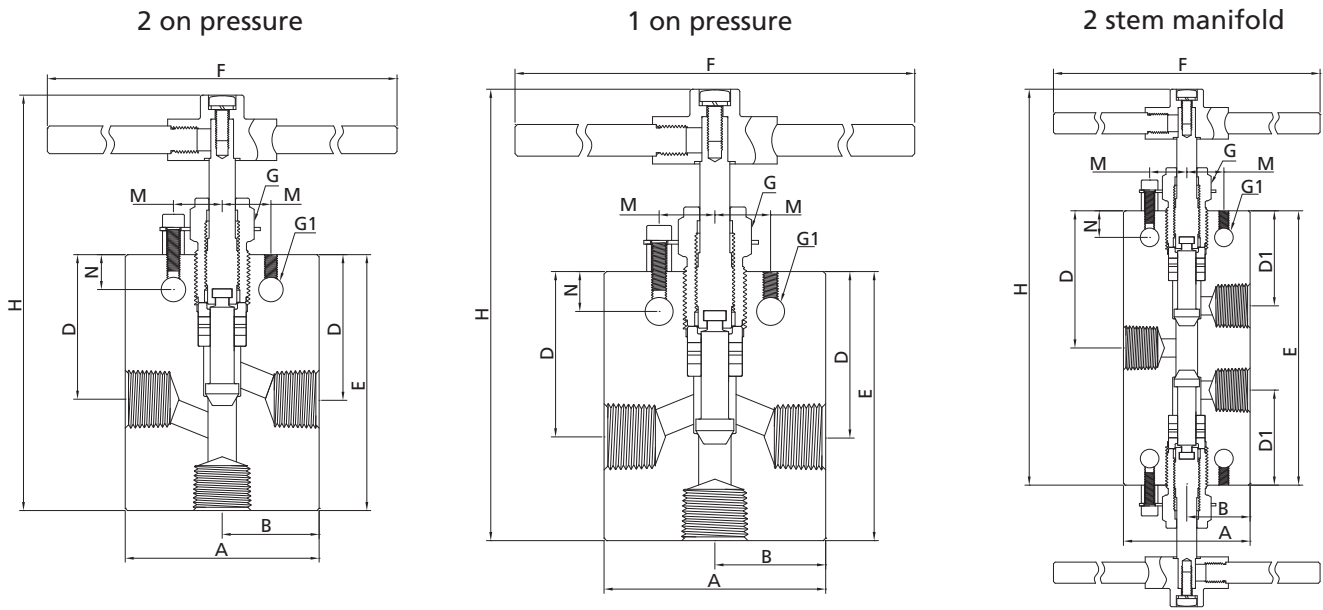

2 on pressure		Orifice in. (mm)	Dimensions, in. (mm)												
Ordering Number	Connection		A	B	C	D	D1	E	F	G	G1	H	M	N	Thickness
10NSS-FNS12-4	FNS12	0.437 (11.10)	3.50 (88.9)	1.75 (44.5)	/	2.65 (67.3)	/	4.62 (117.4)	10.25 (260.4)	1.19 (30.2)	0.44 (11.2)	8.40 (213.4)	0.88 (22.4)	0.63 (16.0)	1.75 (44.5)
10NSS-FRT12-4	FRT12														
10NSS-FNS16-4	FNS16	0.562 (14.27)	4.12 (104.7)	2.06 (52.3)	/	3.31 (84.1)	/	5.88 (149.4)	10.25 (260.4)	1.64 (41.2)	0.56 (14.2)	10.70 (271.7)	1.25 (31.8)	1.13 (28.7)	1.75 (44.5)
10NSS-FRT16-4	FRT16														

1 on pressure		Orifice in. (mm)	Dimensions, in. (mm)												
Ordering Number	Connection		A	B	C	D	D1	E	F	G	G1	H	M	N	Thickness
10NSS-FNS12-5	FNS12	0.437 (11.10)	3.50 (88.9)	1.75 (44.5)	/	2.65 (67.3)	/	4.25 (107.9)	10.25 (260.4)	1.19 (30.2)	0.44 (11.2)	7.92 (201.3)	0.88 (22.4)	0.63 (16.0)	1.75 (44.5)
10NSS-FRT12-5	FRT12														
10NSS-FNS16-5	FNS16	0.562 (14.27)	4.12 (104.7)	2.06 (52.3)	/	3.31 (84.1)	/	5.12 (130.1)	10.25 (260.4)	1.62 (41.2)	0.56 (14.2)	9.94 (252.5)	1.25 (31.8)	1.13 (28.7)	1.75 (44.5)
10NSS-FRT16-5	FRT16														

2 stem manifold		Orifice in. (mm)	Dimensions, in. (mm)												
Ordering Number	Connection		A	B	C	D	D1	E	F	G	G1	H	M	N	Thickness
10NSS-FNS12-6	FNS12	0.437 (11.10)	3.50 (88.9)	1.75 (44.5)	/	3.25 (82.6)	2.25 (57.2)	6.50 (165.1)	10.25 (260.4)	1.19 (30.2)	0.44 (11.2)	10.28 (261.2)	0.88 (22.4)	0.63 (16.0)	1.75 (44.5)
10NSS-FRT12-6	FRT12														
10NSS-FNS16-6	FNS16	0.562 (14.27)	4.12 (104.7)	2.06 (52.3)	/	3.75 (95.3)	2.81 (71.42)	7.50 (190.5)	10.25 (260.4)	1.62 (41.2)	0.56 (14.2)	12.32 (313.0)	1.25 (31.8)	1.13 (28.7)	1.75 (44.5)
10NSS-FRT16-6	FRT16														

- NOTES: 1. G is the drill dimension of packing gland mounting hole.
 2. G1 is the dimension of bracket mounting hole.
 3. Panel mounting drill size: 0.25" all valves.
 4. H is the dimension of stem in closed position.
 5. All dimensions for reference only and subject to change. For dimensions not shown above, please contact the FITOK group or our authorized distributors.

Medium & High Pressure Fittings and Tubing

Quick Couplings

Medium & High Pressure Valves

Line Filters

Sour Service Products

Subsea Valves

Tools and Installation Instructions

Technical Information

15N Series

15,000 psig (1034 bar)

Features

- ⊙ High tensile 316 Stainless Steel for valve body and 17-4PH Stainless Steel for lower stem
- ⊙ Selected materials of packing gland and upper stem for optimum thread cycle life and reduced handle torque
- ⊙ Metal-to-metal seating achieves ideal shutoff, longer stem/seat service lifetime for abrasive flow, excellent corrosion resistance and greater durability for repeated on/off cycles
- ⊙ Non-rotating stem and bar stock body design
- ⊙ Easy to assemble and replace packing
- ⊙ Packing located under stem threads
- ⊙ Reliable locking for packing gland
- ⊙ Options for Vee or Regulating stem tips
- ⊙ Five flow patterns available

Technical Data

Connection Size	Connection	Orifice in. (mm)	Cv	Working Pressure psig (bar)	Working Temperature Range
1/8" O.D. Tubing	DHL2	0.094 (2.39)	0.12	15, 000 (1034)	-100°F~800°F (-73°C~427°C)
1/4" O.D. Tubing	DHL4	0.188 (4.77)	0.65	15, 000 (1034)	
3/8" O.D. Tubing	DHL6	0.250 (6.35)	0.95	15, 000 (1034)	
1/2" O.D. Tubing	DHL8	0.375 (9.53)	1.90	15, 000 (1034)	
1/8" Female NPT	FNS2	0.078 (1.98)	0.11	15, 000 (1034)	-100°F~400°F (-73°C~204°C)
1/8" Female ISO/BSP Tapered	FRT2				
1/4" Female NPT	FNS4	0.203 (5.16)	0.63	15, 000 (1034)	
1/4" Female ISO/BSP Tapered	FRT4				
3/8" Female NPT	FNS6	0.219 (5.56)	0.75	15, 000 (1034)	
3/8" Female ISO/BSP Tapered	FRT6				
1/2" Female NPT	FNS8	0.312 (7.92)	1.30	15, 000 (1034)	
1/2" Female ISO/BSP Tapered	FRT8				

NOTES: 1. The values of Cv shown are for 2-way straight valve pattern.

2. The values of Cv for 2-way angle pattern will increase by about 50% (Based on water).

3. Packing Options

PTFE is the standard packing material, RPTFE glass and Graphite also available. Graphite packing not recommended for Hydrogen or Helium service.

PTFE: -100°F~450°F (-73°C~232°C)

RPTFE glass: -100°F~600°F (-73°C~316°C)

Graphite: 0°F~800°F (-17.8°C~427°C)

Ordering Information and Dimensions (Tubing Connection, 2-Way)

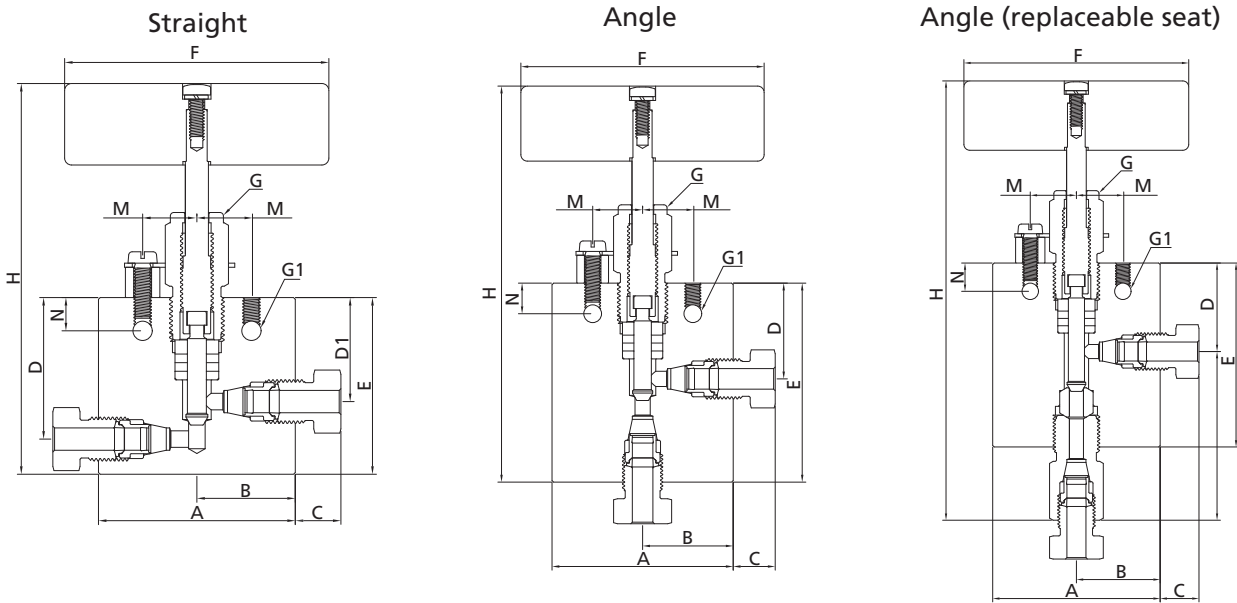

Straight															
Ordering Number	Connection	Orifice in. (mm)	Dimensions, in. (mm)												
			A	B	C	D	D1	E	F	G	G1	H	M	N	Thickness
15NSS-DHL2-1	DHL2	0.094 (2.39)	1.81 (46.1)	0.91 (23.1)	0.44 (11.2)	1.06 (26.9)	0.81 (20.6)	1.38 (35.1)	1.75 (44.5)	0.62 (15.8)	0.17 (4.3)	3.13 (79.6)	0.56 (14.2)	0.31 (7.9)	0.62 (15.8)
15NSS-DHL4-1	DHL4	0.188 (4.77)	2.33 (59.2)	1.17 (29.6)	0.52 (13.3)	1.62 (41.2)	1.19 (30.2)	2.00 (50.8)	3.00 (76.2)	0.75 (19.1)	0.22 (5.6)	4.90 (124.5)	0.62 (15.8)	0.38 (9.7)	0.75 (19.1)
15NSS-DHL6-1	DHL6	0.250 (6.35)	2.27 (57.6)	1.13 (28.8)	0.54 (13.6)	1.62 (41.2)	1.19 (30.2)	2.00 (50.8)	3.00 (76.2)	0.75 (19.1)	0.22 (5.6)	4.97 (126.3)	0.62 (15.8)	0.38 (9.7)	0.75 (19.1)
15NSS-DHL8-1	DHL8	0.375 (9.53)	2.86 (72.7)	1.43 (36.4)	0.60 (15.3)	2.38 (60.5)	1.75 (44.5)	2.88 (73.2)	4.00 (101.6)	1.00 (25.4)	0.34 (8.6)	6.21 (157.7)	0.69 (17.5)	0.50 (12.7)	1.00 (25.4)

Angle															
Ordering Number	Connection	Orifice in. (mm)	Dimensions, in. (mm)												
			A	B	C	D	D1	E	F	G	G1	H	M	N	Thickness
15NSS-DHL2-2	DHL2	0.094 (2.39)	1.81 (46.1)	0.91 (23.1)	0.44 (11.2)	0.81 (20.6)		1.56 (39.6)	1.75 (44.5)	0.62 (15.8)	0.17 (4.3)	3.32 (84.3)	0.56 (14.2)	0.31 (7.9)	0.62 (15.8)
15NSS-DHL4-2	DHL4	0.188 (4.77)	2.33 (59.2)	1.17 (29.6)	0.52 (13.3)	1.19 (30.2)		2.43 (61.7)	3.00 (76.2)	0.75 (19.1)	0.22 (5.6)	5.33 (135.4)	0.62 (15.8)	0.38 (9.7)	0.75 (19.1)
15NSS-DHL6-2	DHL6	0.250 (6.35)	2.27 (57.6)	1.13 (28.8)	0.54 (13.6)	1.19 (30.2)		2.43 (61.7)	3.00 (76.2)	0.75 (19.1)	0.22 (5.6)	5.40 (137.2)	0.62 (15.8)	0.38 (9.7)	0.75 (19.1)
15NSS-DHL8-2	DHL8	0.375 (9.53)	2.86 (72.7)	1.43 (36.4)	0.60 (15.3)	1.75 (44.5)		3.38 (85.9)	4.00 (101.6)	1.00 (25.4)	0.34 (8.6)	6.71 (170.4)	0.69 (17.5)	0.50 (12.7)	1.00 (25.4)

Angle (replaceable seat)															
Ordering Number	Connection	Orifice in. (mm)	Dimensions, in. (mm)												
			A	B	C	D	D1	E	F	G	G1	H	M	N	Thickness
15NSS-DHL2-3	DHL2	0.094 (2.39)	1.81 (46.1)	0.91 (23.1)	0.44 (11.2)	0.81 (20.6)	1.44 (36.5)	1.56 (39.6)	1.75 (44.5)	0.62 (15.8)	0.17 (4.3)	3.84 (97.6)	0.56 (14.2)	0.31 (7.9)	0.62 (15.8)
15NSS-DHL4-3	DHL4	0.188 (4.77)	2.33 (59.2)	1.17 (29.6)	0.52 (13.3)	1.19 (30.2)	2.05 (52.0)	2.25 (57.2)	3.00 (76.2)	0.75 (19.1)	0.22 (5.6)	5.97 (151.6)	0.62 (15.8)	0.38 (9.7)	0.75 (19.1)
15NSS-DHL6-3	DHL6	0.250 (6.35)	2.27 (57.6)	1.13 (28.8)	0.54 (13.6)	1.19 (30.2)	2.32 (59.0)	2.25 (57.2)	3.00 (76.2)	0.75 (19.1)	0.22 (5.6)	6.35 (161.3)	0.62 (15.8)	0.38 (9.7)	0.75 (19.1)
15NSS-DHL8-3	DHL8	0.375 (9.53)	2.86 (72.7)	1.43 (36.4)	0.60 (15.3)	1.75 (44.5)	2.68 (68.1)	3.25 (82.6)	4.00 (101.6)	1.00 (25.4)	0.34 (8.6)	7.54 (191.5)	0.69 (17.5)	0.50 (12.7)	1.00 (25.4)

Medium & High Pressure Fittings and Tubing
Quick Couplings
Medium & High Pressure Valves
Line Filters
Sour Service Products
Subsea Valves
Tools and Installation Instructions
Technical Information

Ordering Information and Dimensions (Tubing Connection, 2-Way)

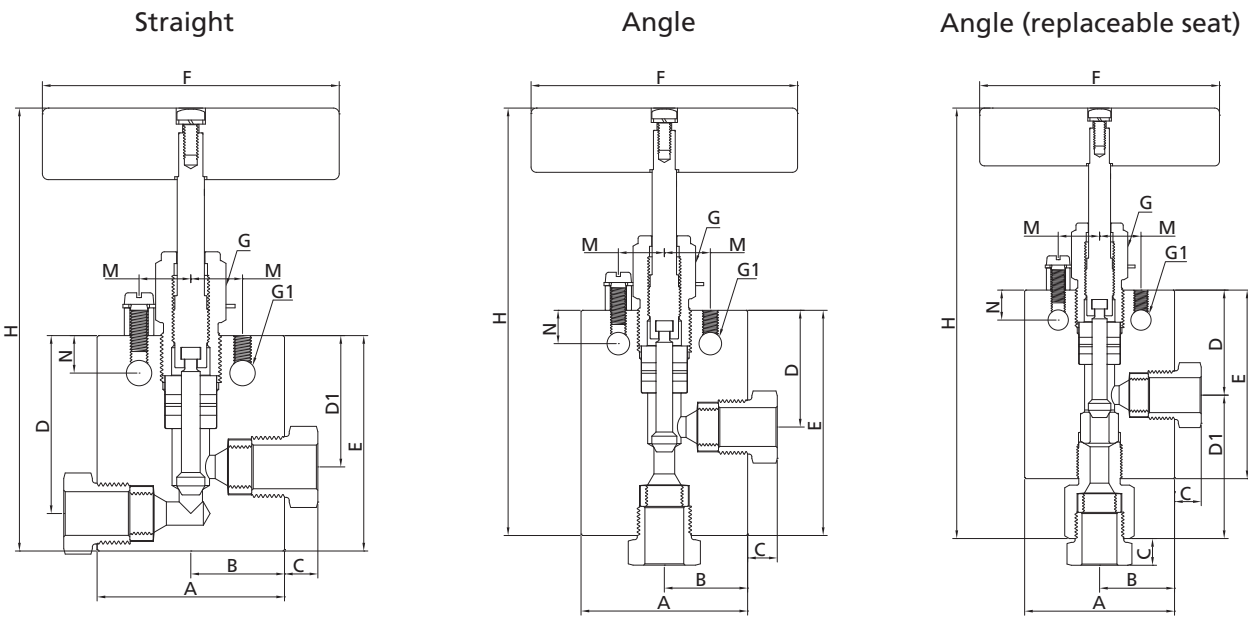

Straight															
Ordering Number	Connection	Orifice in. (mm)	Dimensions, in. (mm)												
			A	B	C	D	D1	E	F	G	G1	H	M	N	Thickness
20NSS-2FH4-1	2FH4	0.125 (3.18)	2.00 (50.8)	1.00 (25.4)	0.38 (9.7)	1.62 (41.2)	1.19 (30.2)	2.00 (50.8)	3.00 (76.2)	0.75 (19.1)	0.22 (5.6)	4.85 (123.1)	0.62 (15.8)	0.38 (9.7)	0.75 (19.1)
20NSS-2FH6-1	2FH6	0.204 (5.18)	2.00 (50.8)	1.00 (25.4)	0.44 (11.2)	1.62 (41.2)	1.19 (30.2)	2.00 (50.8)	3.00 (76.2)	0.75 (19.1)	0.22 (5.6)	4.89 (124.2)	0.62 (15.8)	0.38 (9.7)	0.75 (19.1)
20NSS-2FH9-1	2FH9	0.312 (7.92)	2.50 (63.5)	1.25 (31.8)	0.55 (14.0)	2.37 (60.3)	1.75 (44.5)	2.88 (73.2)	4.00 (101.6)	1.00 (25.4)	0.34 (8.6)	6.18 (157.2)	0.69 (17.5)	0.50 (12.7)	1.00 (25.4)
20NSS-2FH12-1	2FH12	0.438 (11.13)	3.00 (76.2)	1.50 (38.1)	0.60 (15.2)	3.00 (76.2)	2.25 (57.2)	3.75 (95.3)	10.25 (260.4)	1.19 (30.2)	0.44 (11.2)	7.37 (187.2)	0.88 (22.4)	0.63 (16.0)	1.38 (35.1)
20NSS-2FH16-1	2FH16	0.562 (14.27)	4.12 (104.6)	2.06 (52.3)	0.74 (18.7)	3.75 (95.3)	2.81 (71.4)	4.63 (117.6)	10.25 (260.4)	1.62 (41.2)	0.56 (14.2)	9.45 (240.1)	1.25 (31.8)	1.13 (28.7)	1.75 (44.5)

Angle															
Ordering Number	Connection	Orifice in. (mm)	Dimensions, in. (mm)												
			A	B	C	D	D1	E	F	G	G1	H	M	N	Thickness
20NSS-2FH4-2	2FH4	0.125 (3.18)	2.00 (50.8)	1.00 (25.4)	0.38 (9.7)	1.19 (30.2)	/	2.44 (61.9)	3.00 (76.2)	0.75 (19.1)	0.22 (5.6)	5.28 (134.2)	0.62 (15.8)	0.38 (9.7)	0.75 (19.1)
20NSS-2FH6-2	2FH6	0.204 (5.18)	2.00 (50.8)	1.00 (25.4)	0.44 (11.2)	1.19 (30.2)	/	2.44 (61.9)	3.00 (76.2)	0.75 (19.1)	0.22 (5.6)	5.33 (135.4)	0.62 (15.8)	0.38 (9.7)	0.75 (19.1)
20NSS-2FH9-2	2FH9	0.312 (7.92)	2.50 (63.5)	1.25 (31.8)	0.55 (14.0)	1.75 (44.5)	/	3.38 (85.9)	4.00 (101.6)	1.00 (25.4)	0.34 (8.6)	6.69 (170.0)	0.69 (17.5)	0.50 (12.7)	1.00 (25.4)
20NSS-2FH12-2	2FH12	0.438 (11.13)	3.00 (76.2)	1.50 (38.1)	0.60 (15.2)	2.25 (57.2)	/	4.25 (108.0)	10.25 (260.4)	1.19 (30.2)	0.44 (11.2)	7.87 (199.9)	0.88 (22.4)	0.63 (16.0)	1.38 (35.1)
20NSS-2FH16-2	2FH16	0.562 (14.27)	4.12 (104.6)	2.06 (52.3)	0.74 (18.7)	2.81 (71.4)	/	5.12 (130.1)	10.25 (260.4)	1.62 (41.2)	0.56 (14.2)	9.94 (252.6)	1.25 (31.8)	1.13 (28.7)	1.75 (44.5)

Medium & High Pressure Fittings and Tubing

Quick Couplings

Medium & High Pressure Valves

Line Filters

Sour Service Products

Subsea Valves

Tools and Installation Instructions

Technical Information

Ordering Information and Dimensions (Tubing Connection, 2-Way)

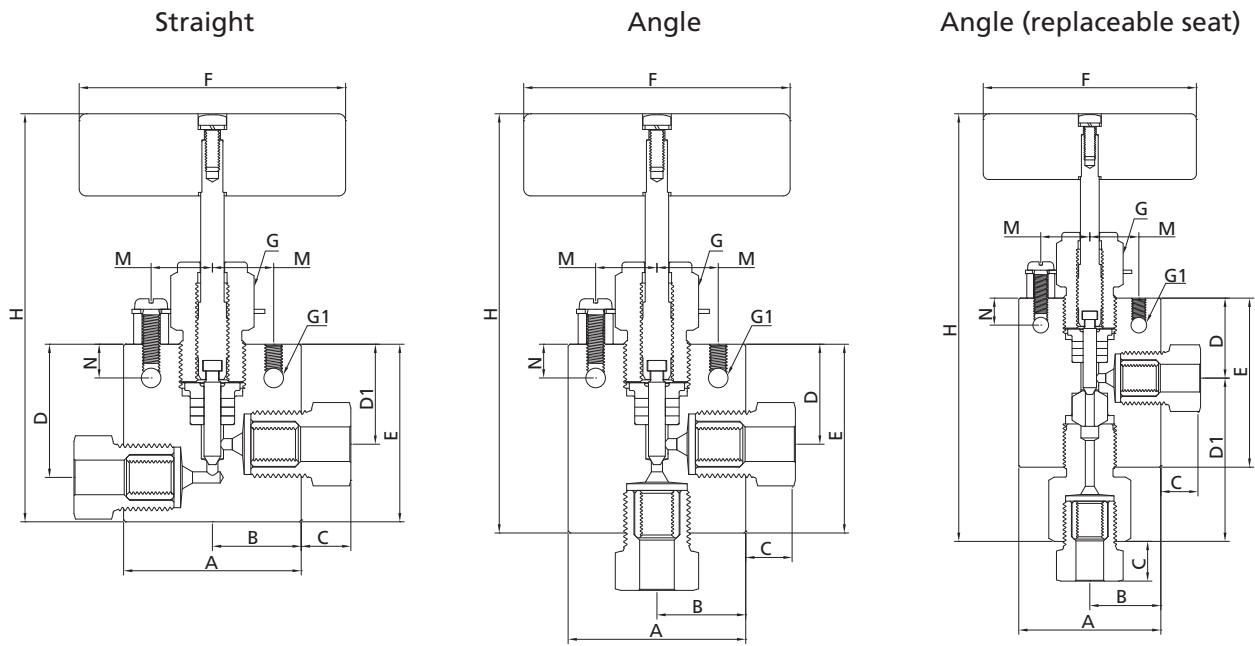

Straight															
Ordering Number	Connection	Orifice in. (mm)	Dimensions, in. (mm)												
			A	B	C	D	D1	E	F	G	G1	H	M	N	Thickness
30NSS-6FH4-1	6FH4	0.094 (2.39)	2.00 (50.8)	1.00 (25.4)	0.47 (11.9)	1.50 (38.1)	1.12 (28.5)	2.00 (50.8)	3.00 (76.2)	1.00 (25.4)	0.22 (5.6)	4.69 (119.1)	0.69 (17.5)	0.38 (9.7)	1.00 (25.4)
30NSS-6FH6-1	6FH6	0.125 (3.18)	2.00 (50.8)	1.00 (25.4)	0.61 (15.6)	1.50 (38.1)	1.12 (28.5)	2.00 (50.8)	3.00 (76.2)	1.00 (25.4)	0.22 (5.6)	4.69 (119.1)	0.69 (17.5)	0.38 (9.7)	1.00 (25.4)
30NSS-6FH9-1	6FH9	0.125 (3.18)	2.62 (66.6)	1.31 (33.3)	0.95 (24.1)	1.56 (39.6)	1.12 (28.5)	2.44 (62.0)	3.00 (76.2)	1.00 (25.4)	0.28 (7.1)	5.13 (130.3)	0.69 (17.5)	0.38 (9.7)	1.50 (38.1)

Angle															
Ordering Number	Connection	Orifice in. (mm)	Dimensions, in. (mm)												
			A	B	C	D	D1	E	F	G	G1	H	M	N	Thickness
30NSS-6FH4-2	6FH4	0.094 (2.39)	2.00 (50.8)	1.00 (25.4)	0.47 (11.9)	1.12 (28.5)	1.12 (28.5)	2.00 (50.8)	3.00 (76.2)	1.00 (25.4)	0.22 (5.6)	4.69 (119.1)	0.69 (17.5)	0.38 (9.7)	1.00 (25.4)
30NSS-6FH6-2	6FH6	0.125 (3.18)	2.00 (50.8)	1.00 (25.4)	0.61 (15.6)	1.12 (28.5)	1.12 (28.5)	2.25 (57.2)	3.00 (76.2)	1.00 (25.4)	0.22 (5.6)	4.95 (125.7)	0.69 (17.5)	0.38 (9.7)	1.00 (25.4)
30NSS-6FH9-2	6FH9	0.125 (3.18)	2.62 (66.6)	1.31 (33.3)	0.95 (24.1)	1.12 (28.5)	1.12 (28.5)	2.44 (62.0)	3.00 (76.2)	1.00 (25.4)	0.28 (7.1)	5.13 (130.3)	0.69 (17.5)	0.38 (9.7)	1.50 (38.1)

Angle (replaceable seat)															
Ordering Number	Connection	Orifice in. (mm)	Dimensions, in. (mm)												
			A	B	C	D	D1	E	F	G	G1	H	M	N	Thickness
30NSS-6FH4-3	6FH4	0.094 (2.39)	2.00 (50.8)	1.00 (25.4)	0.47 (11.9)	1.12 (28.5)	2.06 (52.3)	2.38 (60.5)	3.00 (76.2)	1.00 (25.4)	0.22 (5.6)	5.88 (149.2)	0.69 (17.5)	0.38 (9.7)	1.00 (25.4)
30NSS-6FH6-3	6FH6	0.125 (3.18)	2.00 (50.8)	1.00 (25.4)	0.61 (15.6)	1.12 (28.5)	2.31 (58.67)	2.38 (60.5)	3.00 (76.2)	1.00 (25.4)	0.22 (5.6)	6.12 (155.4)	0.69 (17.5)	0.38 (9.7)	1.00 (25.4)
30NSS-6FH9-3	6FH9	0.125 (3.18)	2.62 (66.6)	1.31 (33.3)	0.95 (24.1)	1.12 (28.6)	2.55 (65.0)	2.44 (62.0)	3.00 (76.2)	1.00 (25.4)	0.28 (7.1)	6.39 (162.4)	0.69 (17.5)	0.38 (9.7)	1.50 (38.1)

Medium & High Pressure Fittings and Tubing
Quick Couplings
Medium & High Pressure Valves
Line Filters
Sour Service Products
Subsea Valves
Tools and Installation Instructions
Technical Information

Ordering Information and Dimensions (Tubing Connection, 2-Way)

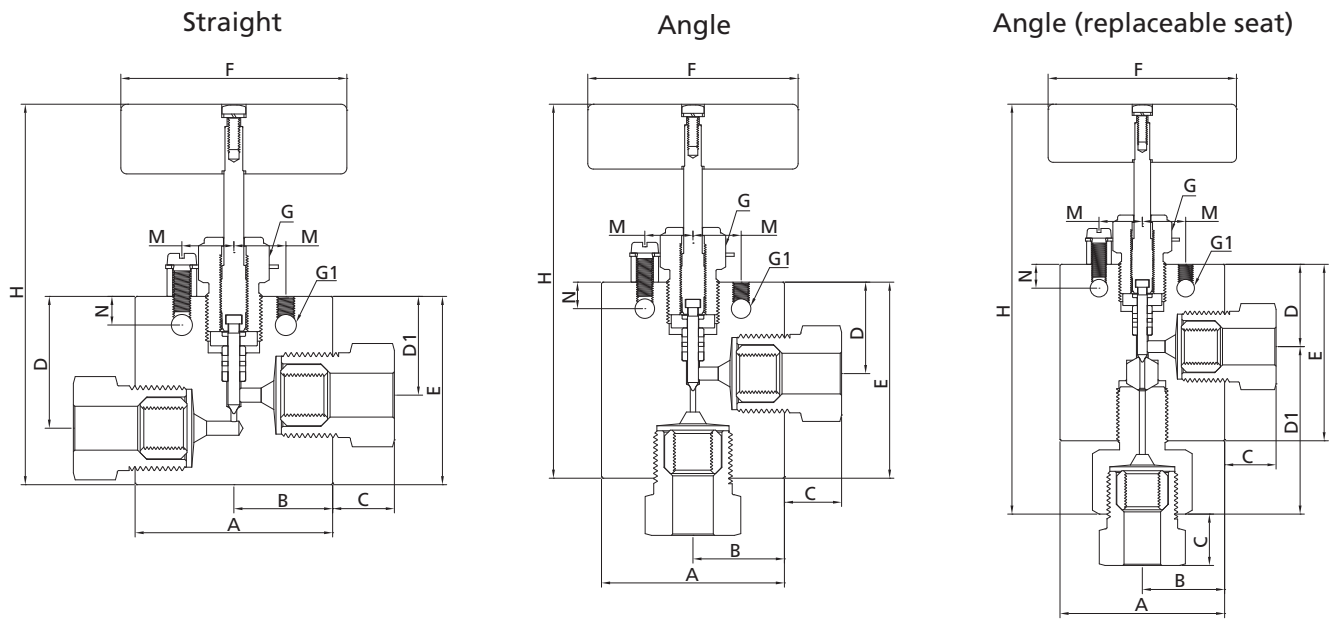

Straight															
Ordering Number	Connection	Orifice in. (mm)	Dimensions, in. (mm)												
			A	B	C	D	D1	E	F	G	G1	H	M	N	Thickness
60NSS-6FH4-1	6FH4	0.063 (1.59)	2.00 (50.8)	1.00 (25.4)	0.47 (11.9)	1.69 (42.9)	1.31 (33.3)	2.13 (54.0)	3.00 (76.2)	1.00 (25.4)	0.22 (5.6)	4.77 (121.1)	0.69 (17.5)	0.38 (9.7)	1.00 (25.4)
60NSS-6FH6-1	6FH6	0.063 (1.59)	2.00 (50.8)	1.00 (25.4)	0.61 (15.6)	1.69 (42.9)	1.31 (33.3)	2.25 (57.2)	3.00 (76.2)	1.00 (25.4)	0.22 (5.6)	4.89 (124.3)	0.69 (17.5)	0.38 (9.7)	1.00 (25.4)
60NSS-6FH9-1	6FH9	0.078 (1.98)	2.62 (66.6)	1.31 (33.3)	0.95 (24.1)	1.75 (44.5)	1.31 (33.3)	2.50 (63.5)	3.00 (76.2)	1.00 (25.4)	0.28 (7.1)	5.14 (130.6)	0.69 (17.5)	0.38 (9.7)	1.50 (38.1)

Angle															
Ordering Number	Connection	Orifice in. (mm)	Dimensions, in. (mm)												
			A	B	C	D	D1	E	F	G	G1	H	M	N	Thickness
60NSS-6FH4-2	6FH4	0.063 (1.59)	2.00 (50.8)	1.00 (25.4)	0.47 (11.9)	1.31 (33.3)	/	2.38 (60.5)	3.00 (76.2)	1.00 (25.4)	0.22 (5.6)	5.02 (127.5)	0.69 (17.5)	0.38 (9.7)	1.00 (25.4)
60NSS-6FH6-2	6FH6	0.063 (1.59)	2.00 (50.8)	1.00 (25.4)	0.61 (15.6)	1.31 (33.3)	/	2.62 (66.6)	3.00 (76.2)	1.00 (25.4)	0.22 (5.6)	5.26 (133.5)	0.69 (17.5)	0.38 (9.7)	1.00 (25.4)
60NSS-6FH9-2	6FH9	0.078 (1.98)	2.62 (66.6)	1.31 (33.3)	0.95 (24.1)	1.31 (33.3)	/	2.81 (71.4)	3.00 (76.2)	1.00 (25.4)	0.28 (7.1)	5.45 (138.5)	0.69 (17.5)	0.38 (9.7)	1.50 (38.1)

Angle (replaceable seat)															
Ordering Number	Connection	Orifice in. (mm)	Dimensions, in. (mm)												
			A	B	C	D	D1	E	F	G	G1	H	M	N	Thickness
60NSS-6FH4-3	6FH4	0.063 (1.59)	2.00 (50.8)	1.00 (25.4)	0.47 (11.9)	1.31 (33.3)	2.12 (53.9)	2.62 (66.6)	3.00 (76.2)	1.00 (25.4)	0.22 (5.6)	6.07 (154.1)	0.69 (17.5)	0.38 (9.7)	1.00 (25.4)
60NSS-6FH6-3	6FH6	0.063 (1.59)	2.00 (50.8)	1.00 (25.4)	0.61 (15.6)	1.31 (33.3)	2.36 (59.9)	2.62 (66.6)	3.00 (76.2)	1.00 (25.4)	0.22 (5.6)	6.30 (160.1)	0.69 (17.5)	0.38 (9.7)	1.00 (25.4)
60NSS-6FH9-3	6FH9	0.078 (1.98)	2.62 (66.6)	1.31 (33.3)	0.95 (24.1)	1.31 (33.3)	2.68 (68.8)	2.62 (66.6)	3.00 (76.2)	1.00 (25.4)	0.28 (7.1)	6.65 (168.9)	0.69 (17.5)	0.38 (9.7)	1.50 (38.1)

Medium & High Pressure Fittings and Tubing
Quick Couplings
Medium & High Pressure Valves
Line Filters
Sour Service Products
Subsea Valves
Tools and Installation Instructions
Technical Information

Air Operator Technical Data

10N Series

10,000 psig (690 bar)

Basic Ordering Number		System Pressure KSI (MPa)								Stem Travel in. (mm)	Flow Coefficient (Cv)
		1-4 (6.9-27.6)	6 (41.4)	8 (55.2)	10 (69.0)						
10NSS-2FH9-X	Air Pressure psig (bar)	25 (1.7)	35 (2.4)	40 (2.8)	50 (3.5)					0.24 (6.0)	1.75
10NSS-2FH12-X	Air Pressure psig (bar)	25 (1.7)	35 (2.4)	45 (3.1)	50 (3.5)					0.35 (9.0)	2.80
10NSS-2FH16-X	Air Pressure psig (bar)	30 (2.1)	40 (2.8)	50 (3.5)	60 (4.2)					0.39 (10.0)	5.20
10NSS-FNS12-X 10NSS-FRT12-X	Air Pressure psig (bar)	25 (1.7)	30 (2.1)	35 (2.4)	40 (2.8)					0.35 (9.0)	2.09
10NSS-FNS16-X 10NSS-FRT16-X	Air Pressure psig (bar)	25 (1.7)	30 (2.1)	40 (2.8)	45 (3.1)					0.39 (10.0)	3.40

NOTES: 1. -X: Designator of valve flow patterns. Valves are available in 6 different flow patterns (-1 to -6). For details please

refer to the FITOK Catalog for Medium & High Pressure Needle Valves.

2. The values of Cv shown are for 2-way straight pattern valves.

3. The values of Cv for 2-way angle patterns will increase by about 50% (with water).

4. All dimensions are for reference only and are subject to change.

Medium & High Pressure Fittings and Tubing

Quick Couplings

Medium & High Pressure Valves

Line Filters

Sour Service Products

Subsea Valves

Tools and Installation Instructions

Technical Information

15N Series
15,000 psig (1034 bar)

Medium & High Pressure Fittings and Tubing
Quick Couplings
Medium & High Pressure Valves
Line Filters
Sour Service Products
Subsea Valves
Tools and Installation Instructions
Technical Information

Basic Ordering Number		System Pressure KSI (MPa)									Stem Travel in. (mm)	Flow Coefficient (Cv)	
		1-4 (6.9-27.6)	6 (41.4)	8 (55.2)	10 (69.0)	12 (82.7)	14 (96.5)	15 (103.4)					
15NSS-DHL2-X	Air Pressure psig (bar)	45 (3.1)	55 (3.8)	60 (4.2)	70 (4.8)	75 (5.2)	85 (5.9)	90 (6.2)				0.12 (3.0)	0.10
15NSS-DHL4-X	Air Pressure psig (bar)	30 (2.1)	35 (2.4)	40 (2.8)	50 (3.5)	55 (3.8)	60 (4.2)	60 (4.2)				0.19 (4.9)	0.54 0.95
15NSS-DHL6-X	Air Pressure psig (bar)	25 (1.7)	35 (2.4)	45 (3.1)	50 (3.5)	60 (4.2)	70 (4.8)	75 (5.2)				0.24 (6.0)	1.90
15NSS-DHL8-X	Air Pressure psig (bar)	65 (4.5)	75 (5.2)	80 (5.5)	90 (6.2)	95 (6.6)	100 (6.9)	100 (6.9)				0.12 (3.0)	0.07
15NSS-FNS2-X	Air Pressure psig (bar)	30 (2.1)	35 (2.4)	40 (2.8)	50 (3.5)	55 (3.8)	60 (4.2)	60 (4.2)				0.19 (4.9)	0.47
15NSS-FNS4-X	Air Pressure psig (bar)	30 (2.1)	35 (2.4)	40 (2.8)	50 (3.5)	55 (3.8)	60 (4.2)	60 (4.2)				0.19 (4.9)	0.59
15NSS-FNS6-X	Air Pressure psig (bar)	20 (1.4)	30 (2.1)	35 (2.4)	40 (2.8)	45 (3.1)	55 (3.8)	55 (3.8)				0.24 (6.0)	1.04
15NSS-FNS8-X	Air Pressure psig (bar)												
15NSS-FRT2-X	Air Pressure psig (bar)												
15NSS-FRT4-X	Air Pressure psig (bar)												
15NSS-FRT6-X	Air Pressure psig (bar)												
15NSS-FRT8-X	Air Pressure psig (bar)												

- NOTES: 1. -X: Designator of valve flow patterns. Valves are available in 6 different flow patterns (-1 to -6). For details, please refer to the FITOK Catalog for Medium & High Pressure Needle Valves.
 2. The values of Cv shown are for 2-way straight pattern valves.
 3. The values of Cv for 2-way angle patterns will increase by about 50% (with water).
 4. All dimensions are for reference only and are subject to change.

30N Series
30,000 psig (2068 bar)

Basic Ordering Number		System Pressure KSI (MPa)										Stem Travel in. (mm)	Flow Coefficient (Cv)
		1-12	14	16	18	20	22	24	26	28	30		
		(6.9-82.7)	(96.5)	(110.3)	(124.1)	(137.9)	(151.7)	(165.7)	(179.3)	(193.1)	(206.8)		
30NSS-6FH4-X	Air Pressure psig (bar)	45	50	55	60	65	70	75	80	85	85	0.19 (4.9)	0.12
30NSS-6FH6-X		(3.1)	(3.5)	(3.8)	(4.1)	(4.5)	(4.8)	(5.2)	(5.5)	(5.9)	(5.9)		0.22
30NSS-6FH9-X													0.31

NOTES: 1. -X: Designator of valve flow patterns. Valves are available in 6 different flow patterns (-1 to -6). For details, please

- refer to the FITOK Catalog for Medium & High Pressure Needle Valves.
- 2. The values of Cv shown are for 2-way straight pattern valves.
- 3. The values of Cv for 2-way angle patterns will increase by about 50% (with water).
- 4. All dimensions are for reference only and are subject to change.

Medium & High Pressure Fittings and Tubing

Quick Couplings

Medium & High Pressure Valves

Line Filters

Sour Service Products

Subsea Valves

Tools and Installation Instructions

Technical Information

60N Series
60,000 psig (4137 bar)

Basic Ordering Number		System Pressure KSI (MPa)										Stem Travel in. (mm)	Flow Coefficient (Cv)
		1-20	25	30	35	40	45	50	55	60			
		(6.9-137.9)	(172.4)	(206.8)	(241.3)	(275.8)	(310.3)	(344.7)	(379.2)	(413.7)			
60NSS-6FH4-X	Air Pressure	35	40	50	55	65	70	75	85	90		0.19	0.08
60NSS-6FH6-X	psig (bar)	(2.4)	(2.8)	(3.5)	(3.8)	(4.5)	(4.8)	(5.2)	(5.9)	(6.2)		(4.9)	0.09
60NSS-6FH9-X													0.14

NOTES: 1. -X: Designator of valve flow patterns. Valves are available in 6 different flow patterns (-1 to -6). For details, please

- refer to the FITOK Catalog for Medium & High Pressure Needle Valves.
- 2. The values of Cv shown are for 2-way straight pattern valves.
- 3. The values of Cv for 2-way angle patterns will increase by about 50% (with water).
- 4. All dimensions are for reference only and are subject to change.

Medium & High Pressure
Fittings and Tubing

Quick Couplings

Medium & High Pressure
Valves

Line Filters

Sour Service Products

Subsea Valves

Tools and Installation
Instructions

Technical Information

20N Series
20,000 psig (1379 bar)

Basic Ordering Number		System Pressure KSI (MPa)										Stem Travel in. (mm)	Flow Coefficient (Cv)
		1-4	6	8	10	12	14	16	18	20			
		(6.9-27.6)	(41.4)	(55.2)	(69.0)	(82.7)	(96.5)	(110.3)	(124.1)	(137.9)			
20NSS-2FH4-X	Air Pressure	30	35	40	50	55	60	65	70	75		0.19	0.29
	psig (bar)	(2.1)	(2.4)	(2.8)	(3.5)	(3.8)	(4.2)	(4.5)	(4.8)	(5.2)		(4.9)	0.62
20NSS-2FH6-X	Air Pressure	20	30	35	40	45	55	60	65	70		0.24	1.30
	psig (bar)	(1.4)	(2.1)	(2.4)	(2.8)	(3.1)	(3.8)	(4.2)	(4.5)	(4.8)		(6.0)	
20NSS-2FH12-X	Air Pressure	25	30	35	40	45	55	60	65	70		0.35	2.41
	psig (bar)	(1.7)	(2.1)	(2.4)	(2.8)	(3.1)	(3.8)	(4.2)	(4.5)	(4.8)		(9.0)	
20NSS-2FH16-X	Air Pressure	25	30	40	45	55	60	65	75	80		0.39	3.40
	psig (bar)	(1.7)	(2.1)	(2.8)	(3.1)	(3.8)	(4.2)	(4.5)	(5.2)	(5.5)		(10.0)	

NOTES: 1. -X: Designator of valve flow patterns. Valves are available in 6 different flow patterns (-1 to -6). For details, please

- refer to the FITOK Catalog for Medium & High Pressure Needle Valves.
- 2. The values of Cv shown are for 2-way straight pattern valves.
- 3. The values of Cv for 2-way angle patterns will increase by about 50% (with water).
- 4. All dimensions are for reference only and are subject to change.

Medium & High Pressure Fittings and Tubing
Quick Couplings
Medium & High Pressure Valves
Line Filters
Sour Service Products
Subsea Valves
Tools and Installation Instructions
Technical Information

Ordering Information and Dimensions (Tubing Connection, 3-Way)

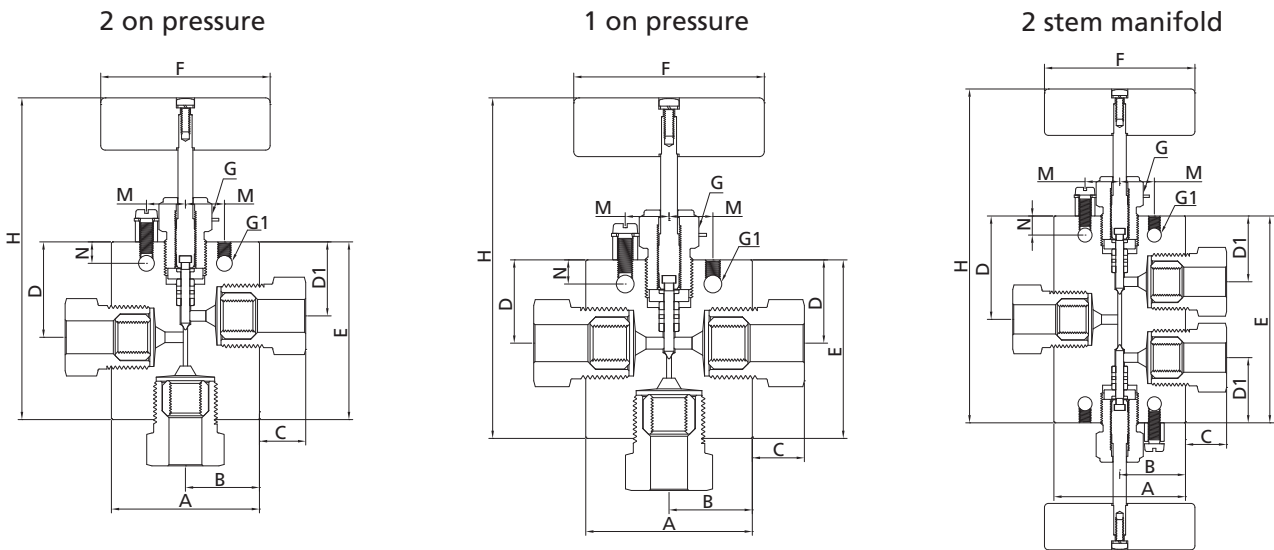

2 on pressure															
Ordering Number	Connection	Orifice in. (mm)	Dimensions, in. (mm)												
			A	B	C	D	D1	E	F	G	G1	H	M	N	Thickness
60NSS-6FH4-4	6FH4	0.063 (1.59)	2.00 (50.8)	1.00 (25.4)	0.47 (11.9)	1.69 (42.9)	1.31 (33.3)	2.38 (60.5)	3.00 (76.2)	1.00 (25.4)	0.22 (5.6)	5.26 (133.6)	0.69 (17.5)	0.38 (9.7)	1.00 (25.4)
60NSS-6FH6-4	6FH6	0.063 (1.59)	2.00 (50.8)	1.00 (25.4)	0.61 (15.6)	1.69 (42.9)	1.31 (33.3)	2.75 (68.9)	3.00 (76.2)	1.00 (25.4)	0.22 (5.6)	5.34 (135.8)	0.69 (17.5)	0.38 (9.7)	1.00 (25.4)
60NSS-6FH9-4	6FH9	0.078 (1.98)	2.62 (66.6)	1.31 (33.3)	0.95 (24.1)	1.75 (44.5)	1.31 (33.3)	3.03 (77.0)	3.00 (76.2)	1.00 (25.4)	0.28 (7.1)	5.67 (143.9)	0.69 (17.5)	0.38 (9.7)	1.50 (38.1)

1 on pressure															
Ordering Number	Connection	Orifice in. (mm)	Dimensions, in. (mm)												
			A	B	C	D	D1	E	F	G	G1	H	M	N	Thickness
60NSS-6FH4-5	6FH4	0.063 (1.59)	2.00 (50.8)	1.00 (25.4)	0.47 (11.9)	1.31 (33.3)	/	2.38 (60.5)	3.00 (76.2)	1.00 (25.4)	0.22 (5.6)	5.02 (127.5)	0.69 (17.5)	0.38 (9.7)	1.00 (25.4)
60NSS-6FH6-5	6FH6	0.063 (1.59)	2.00 (50.8)	1.00 (25.4)	0.61 (15.6)	1.31 (33.3)	/	2.62 (66.6)	3.00 (76.2)	1.00 (25.4)	0.22 (5.6)	5.26 (133.5)	0.69 (17.5)	0.38 (9.7)	1.00 (25.4)
60NSS-6FH9-5	6FH9	0.078 (1.98)	2.62 (66.6)	1.31 (33.3)	0.95 (24.1)	1.31 (33.3)	/	2.81 (71.4)	3.00 (76.2)	1.00 (25.4)	0.28 (7.1)	5.45 (138.5)	0.69 (17.5)	0.38 (9.7)	1.50 (38.1)

2 stem manifold															
Ordering Number	Connection	Orifice in. (mm)	Dimensions, in. (mm)												
			A	B	C	D	D1	E	F	G	G1	H	M	N	Thickness
60NSS-6FH4-6	6FH4	0.063 (1.59)	2.00 (50.8)	1.00 (25.4)	0.47 (11.9)	1.72 (43.69)	1.31 (33.3)	3.44 (87.4)	3.00 (76.2)	1.00 (25.4)	0.22 (5.6)	6.08 (154.5)	0.69 (17.5)	0.38 (9.7)	1.00 (25.4)
60NSS-6FH6-6	6FH6	0.063 (1.59)	2.00 (50.8)	1.00 (25.4)	0.61 (15.6)	1.88 (47.8)	1.31 (33.3)	3.75 (95.3)	3.00 (76.2)	1.00 (25.4)	0.22 (5.6)	6.39 (162.3)	0.69 (17.5)	0.38 (9.7)	1.00 (25.4)
60NSS-6FH9-6	6FH9	0.078 (1.98)	2.62 (66.6)	1.31 (33.3)	0.95 (24.1)	2.06 (52.3)	1.31 (33.3)	4.12 (104.7)	3.00 (76.2)	1.00 (25.4)	0.28 (7.1)	6.76 (171.8)	0.69 (17.5)	0.38 (9.7)	1.50 (38.1)

- NOTES: 1. G is the drill dimension of packing gland mounting hole.
 2. G1 is the dimension of bracket mounting hole.
 3. Panel mounting drill size: 0.25" all valves.
 4. H is the dimension of stem in closed position.
 5. All dimensions for reference only and subject to change. For dimensions not shown above, please contact the FITOK Group or our authorized representatives.

Medium & High Pressure Fittings and Tubing

Quick Couplings

Medium & High Pressure Valves

Line Filters

Sour Service Products

Subsea Valves

Tools and Installation Instructions

Technical Information

Ordering Information and Dimensions (Tubing Connection, 3-Way)

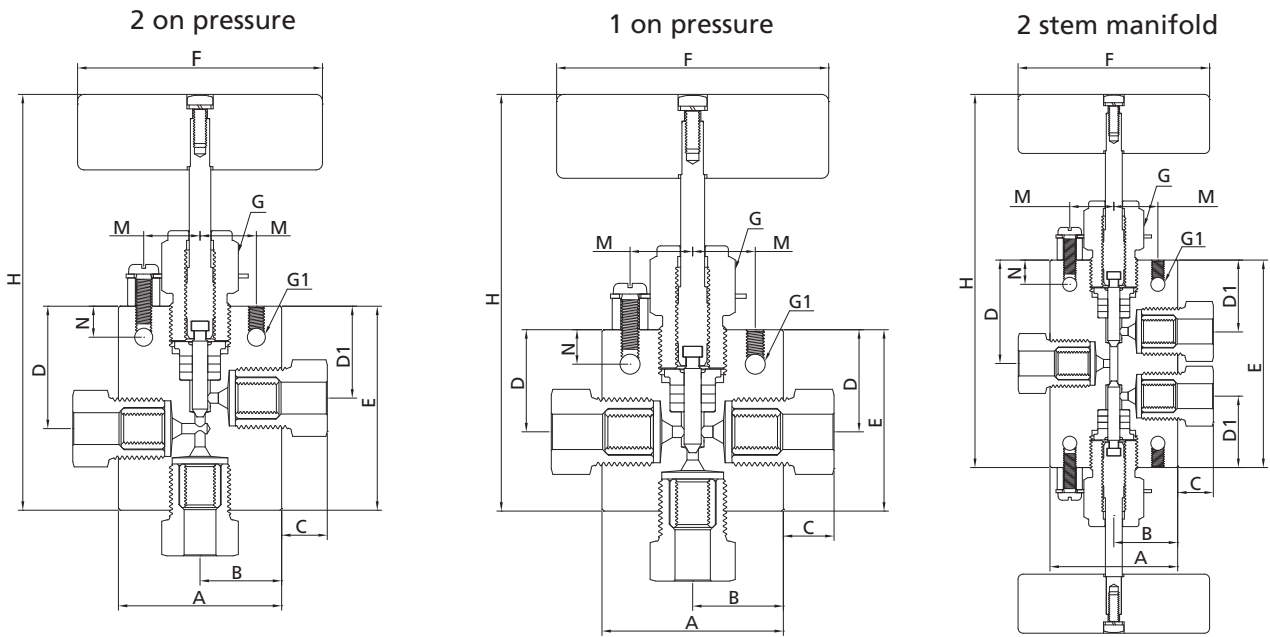

2 on pressure															
Ordering Number	Connection	Orifice in. (mm)	Dimensions, in. (mm)												
			A	B	C	D	D1	E	F	G	G1	H	M	N	Thickness
30NSS-6FH4-4	6FH4	0.094 (2.39)	2.00 (50.8)	1.00 (25.4)	0.47 (11.9)	1.50 (38.1)	1.12 (28.5)	2.12 (53.9)	3.00 (76.2)	1.00 (25.4)	0.22 (5.6)	4.81 (122.1)	0.69 (17.5)	0.38 (9.7)	1.00 (25.4)
30NSS-6FH6-4	6FH6	0.125 (3.18)	2.00 (50.8)	1.00 (25.4)	0.61 (15.6)	1.50 (38.1)	1.12 (28.5)	2.50 (63.5)	3.00 (76.2)	1.00 (25.4)	0.22 (5.6)	5.19 (131.9)	0.69 (17.5)	0.38 (9.7)	1.00 (25.4)
30NSS-6FH9-4	6FH9	0.125 (3.18)	2.62 (66.6)	1.31 (33.3)	0.95 (24.1)	1.56 (39.6)	1.12 (28.5)	2.88 (73.2)	3.00 (76.2)	1.00 (25.4)	0.28 (7.1)	5.57 (141.5)	0.69 (17.5)	0.38 (9.7)	1.50 (38.1)

1 on pressure															
Ordering Number	Connection	Orifice in. (mm)	Dimensions, in. (mm)												
			A	B	C	D	D1	E	F	G	G1	H	M	N	Thickness
30NSS-6FH4-5	6FH4	0.094 (2.39)	2.00 (50.8)	1.00 (25.4)	0.47 (11.9)	1.12 (28.5)	/	2.00 (50.8)	3.00 (76.2)	1.00 (25.4)	0.22 (5.6)	4.69 (119.1)	0.69 (17.5)	0.38 (9.7)	1.00 (25.4)
30NSS-6FH6-5	6FH6	0.125 (3.18)	2.00 (50.8)	1.00 (25.4)	0.61 (15.6)	1.12 (28.5)	/	2.25 (57.2)	3.00 (76.2)	1.00 (25.4)	0.22 (5.6)	4.95 (125.7)	0.69 (17.5)	0.38 (9.7)	1.00 (25.4)
30NSS-6FH9-5	6FH9	0.125 (3.18)	2.62 (66.6)	1.31 (33.3)	0.95 (24.1)	1.12 (28.5)	/	2.44 (62.0)	3.00 (76.2)	1.00 (25.4)	0.28 (7.1)	5.13 (130.3)	0.69 (17.5)	0.38 (9.7)	1.50 (38.1)

2 stem manifold															
Ordering Number	Connection	Orifice in. (mm)	Dimensions, in. (mm)												
			A	B	C	D	D1	E	F	G	G1	H	M	N	Thickness
30NSS-6FH4-6	6FH4	0.094 (2.39)	2.00 (50.8)	1.00 (25.4)	0.47 (11.9)	1.53 (38.9)	1.12 (28.5)	3.06 (77.7)	3.00 (76.2)	1.00 (25.4)	0.22 (5.6)	5.75 (146.0)	0.69 (17.5)	0.38 (9.7)	1.00 (25.4)
30NSS-6FH6-6	6FH6	0.125 (3.18)	2.00 (50.8)	1.00 (25.4)	0.61 (15.6)	1.62 (41.2)	1.12 (28.5)	3.25 (82.6)	3.00 (76.2)	1.00 (25.4)	0.22 (5.6)	5.94 (150.9)	0.69 (17.5)	0.38 (9.7)	1.00 (25.4)
30NSS-6FH9-6	6FH9	0.125 (3.18)	2.62 (66.6)	1.31 (33.3)	0.95 (24.1)	1.88 (47.8)	1.12 (28.5)	3.75 (95.3)	3.00 (76.2)	1.00 (25.4)	0.28 (7.1)	6.44 (163.6)	0.69 (17.5)	0.38 (9.7)	1.50 (38.1)

- NOTES: 1. G is the drill dimension of packing gland mounting hole.
 2. G1 is the dimension of bracket mounting hole.
 3. Panel mounting drill size: 0.25" all valves.
 4. H is the dimension of stem in closed position.
 5. All dimensions for reference only and subject to change. For dimensions not shown above, please contact the FITOK Group or our authorized representatives.

Medium & High Pressure Fittings and Tubing

Quick Couplings

Medium & High Pressure Valves

Line Filters

Sour Service Products

Subsea Valves

Tools and Installation Instructions

Technical Information

C-29 Needle Valves and Pneumatic Needle Valves

Angle (replaceable seat)															
Ordering Number	Connection	Orifice in. (mm)	Dimensions, in. (mm)												
			A	B	C	D	D1	E	F	G	G1	H	M	N	Thickness
20NSS-2FH4-3	2FH4	0.125 (3.18)	2.00 (50.8)	1.00 (25.4)	0.38 (9.7)	1.19 (30.2)	2.13 (54.0)	2.25 (57.2)	3.00 (76.2)	0.75 (19.1)	0.22 (5.6)	6.10 (154.9)	0.62 (15.8)	0.38 (9.7)	0.75 (19.1)
20NSS-2FH6-3	2FH6	0.204 (5.18)	2.00 (50.8)	1.00 (25.4)	0.44 (11.2)	1.19 (30.2)	2.13 (54.0)	2.25 (57.2)	3.00 (76.2)	0.75 (19.1)	0.22 (5.6)	6.16 (156.5)	0.62 (15.8)	0.38 (9.7)	0.75 (19.1)
20NSS-2FH9-3	2FH9	0.312 (7.92)	2.50 (63.5)	1.25 (31.8)	0.55 (14.0)	1.75 (44.5)	2.50 (63.5)	3.13 (79.4)	4.00 (101.6)	1.00 (25.4)	0.34 (8.6)	7.58 (192.1)	0.69 (17.5)	0.50 (12.7)	1.00 (25.4)
20NSS-2FH12-3	2FH12	0.438 (11.13)	3.00 (76.2)	1.50 (38.1)	0.60 (15.2)	2.25 (57.2)	3.44 (87.4)	4.25 (108.0)	10.25 (260.4)	1.19 (30.2)	0.44 (11.2)	9.30 (236.3)	0.88 (22.4)	0.63 (16.0)	1.38 (35.1)
20NSS-2FH16-3	2FH16	0.562 (14.27)	4.12 (104.6)	2.06 (52.3)	0.74 (18.7)	2.81 (71.4)	4.22 (107.4)	5.25 (133.4)	10.25 (260.4)	1.62 (41.2)	0.56 (14.2)	11.86 (301.3)	1.25 (31.8)	1.13 (28.7)	1.75 (44.5)

Ordering Information and Dimensions (Tubing Connection, 3-Way)

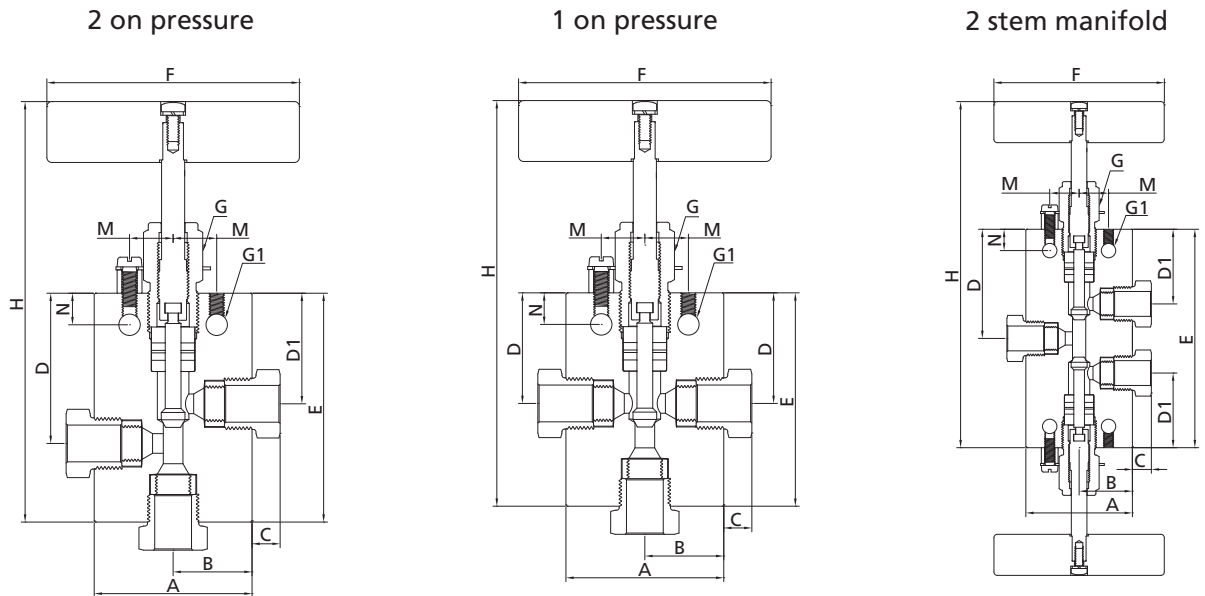

2 on pressure															
Ordering Number	Connection	Orifice in. (mm)	Dimensions, in. (mm)												
			A	B	C	D	D1	E	F	G	G1	H	M	N	Thickness
20NSS-2FH4-4	2FH4	0.125 (3.18)	2.00 (50.8)	1.00 (25.4)	0.38 (9.7)	1.63 (41.3)	1.19 (30.2)	2.63 (66.7)	3.00 (76.2)	0.75 (19.1)	0.22 (5.6)	5.47 (139.0)	0.62 (15.8)	0.38 (9.7)	0.75 (19.1)
20NSS-2FH6-4	2FH6	0.204 (5.18)	2.00 (50.8)	1.00 (25.4)	0.44 (11.2)	1.63 (41.3)	1.19 (30.2)	2.63 (66.7)	3.00 (76.2)	0.75 (19.1)	0.22 (5.6)	5.52 (140.1)	0.62 (15.8)	0.38 (9.7)	0.75 (19.1)
20NSS-2FH9-4	2FH9	0.312 (7.92)	2.50 (63.5)	1.25 (31.8)	0.55 (14.0)	2.37 (60.3)	1.75 (44.5)	3.63 (92.1)	4.00 (101.6)	1.00 (25.4)	0.34 (8.6)	6.94 (176.3)	0.69 (17.5)	0.50 (12.7)	1.00 (25.4)
20NSS-2FH12-4	2FH12	0.438 (11.13)	3.00 (76.2)	1.50 (38.1)	0.60 (15.2)	3.00 (76.2)	2.25 (57.2)	4.63 (117.5)	10.25 (260.4)	1.19 (30.2)	0.44 (11.2)	8.24 (209.4)	0.88 (22.4)	0.63 (16.0)	1.38 (35.1)
20NSS-2FH16-4	2FH16	0.562 (14.27)	4.12 (104.6)	2.06 (52.3)	0.74 (18.7)	3.75 (95.3)	2.81 (71.4)	5.88 (149.4)	10.25 (260.4)	1.62 (41.2)	0.56 (14.2)	10.70 (271.9)	1.25 (31.8)	1.13 (28.7)	1.75 (44.5)

Medium & High Pressure Fittings and Tubing
Quick Couplings
Medium & High Pressure Valves
Line Filters
Sour Service Products
Subsea Valves
Tools and Installation Instructions
Technical Information

1 on pressure															
Ordering Number	Connection	Orifice in. (mm)	Dimensions, in. (mm)												
			A	B	C	D	D1	E	F	G	G1	H	M	N	Thickness
20NSS-2FH4-5	2FH4	0.125 (3.18)	2.00 (50.8)	1.00 (25.4)	0.38 (9.7)	1.19 (30.2)		2.44 (61.9)	3.00 (76.2)	0.75 (19.1)	0.22 (5.6)	5.28 (134.2)	0.62 (15.8)	0.38 (9.7)	0.75 (19.1)
20NSS-2FH6-5	2FH6	0.204 (5.18)	2.00 (50.8)	1.00 (25.4)	0.44 (11.2)	1.19 (30.2)		2.44 (61.9)	3.00 (76.2)	0.75 (19.1)	0.22 (5.6)	5.33 (135.4)	0.62 (15.8)	0.38 (9.7)	0.75 (19.1)
20NSS-2FH9-5	2FH9	0.312 (7.92)	2.50 (63.5)	1.25 (31.8)	0.55 (14.0)	1.75 (44.5)		3.38 (85.9)	4.00 (101.6)	1.00 (25.4)	0.34 (8.6)	6.69 (170.0)	0.69 (17.5)	0.50 (12.7)	1.00 (25.4)
20NSS-2FH12-5	2FH12	0.438 (11.13)	3.00 (76.2)	1.50 (38.1)	0.60 (15.2)	2.25 (57.2)		4.25 (108.0)	10.25 (260.4)	1.19 (30.2)	0.44 (11.2)	7.87 (199.9)	0.88 (22.4)	0.63 (16.0)	1.38 (35.1)
20NSS-2FH16-5	2FH16	0.562 (14.27)	4.12 (104.6)	2.06 (52.3)	0.74 (18.7)	2.81 (71.4)		5.12 (130.1)	10.25 (260.4)	1.62 (41.2)	0.56 (14.2)	9.94 (252.6)	1.25 (31.8)	1.13 (28.7)	1.75 (44.5)

2 stem manifold															
Ordering Number	Connection	Orifice in. (mm)	Dimensions, in. (mm)												
			A	B	C	D	D1	E	F	G	G1	H	M	N	Thickness
20NSS-2FH4-6	2FH4	0.125 (3.18)	2.00 (50.8)	1.00 (25.4)	0.38 (9.7)	1.69 (42.9)	1.19 (30.2)	3.38 (85.7)	3.00 (76.2)	0.75 (19.1)	0.22 (5.6)	6.23 (158.1)	0.62 (15.8)	0.38 (9.7)	0.75 (19.1)
20NSS-2FH6-6	2FH6	0.204 (5.18)	2.00 (50.8)	1.00 (25.4)	0.44 (11.2)	1.69 (42.9)	1.19 (30.2)	3.38 (85.7)	3.00 (76.2)	0.75 (19.1)	0.22 (5.6)	6.24 (158.6)	0.62 (15.8)	0.38 (9.7)	0.75 (19.1)
20NSS-2FH9-6	2FH9	0.312 (7.92)	2.50 (63.5)	1.25 (31.8)	0.55 (14.0)	2.56 (65.1)	1.75 (44.5)	5.13 (130.2)	4.00 (101.6)	1.00 (25.4)	0.34 (8.6)	8.44 (214.4)	0.69 (17.5)	0.50 (12.7)	1.00 (25.4)
20NSS-2FH12-6	2FH12	0.438 (11.13)	3.00 (76.2)	1.50 (38.1)	0.60 (15.2)	3.00 (76.2)	2.25 (57.2)	6.50 (165.1)	10.25 (260.4)	1.19 (30.2)	0.44 (11.2)	10.11 (257.0)	0.88 (22.4)	0.63 (16.0)	1.38 (35.1)
20NSS-2FH16-6	2FH16	0.562 (14.27)	4.12 (104.6)	2.06 (52.3)	0.74 (18.7)	3.75 (95.3)	2.81 (71.4)	7.50 (190.5)	10.25 (260.4)	1.62 (41.2)	0.56 (14.2)	12.32 (313.0)	1.25 (31.8)	1.13 (28.7)	1.75 (44.5)

- NOTES: 1. G is the drill dimension of packing gland mounting hole.
 2. G1 is the dimension of bracket mounting hole.
 3. Panel mounting drill size: 0.25" all valves.
 4. H is the dimension of stem in closed position.
 5. All dimensions for reference only and subject to change. For dimensions not shown above, please contact the FITOK Group or our authorized distributors.

Medium & High Pressure Fittings and Tubing
Quick Couplings
Medium & High Pressure Valves
Line Filters
Sour Service Products
Subsea Valves
Tools and Installation Instructions
Technical Information

Ordering Information and Dimensions (Tubing Connection, 3-Way)

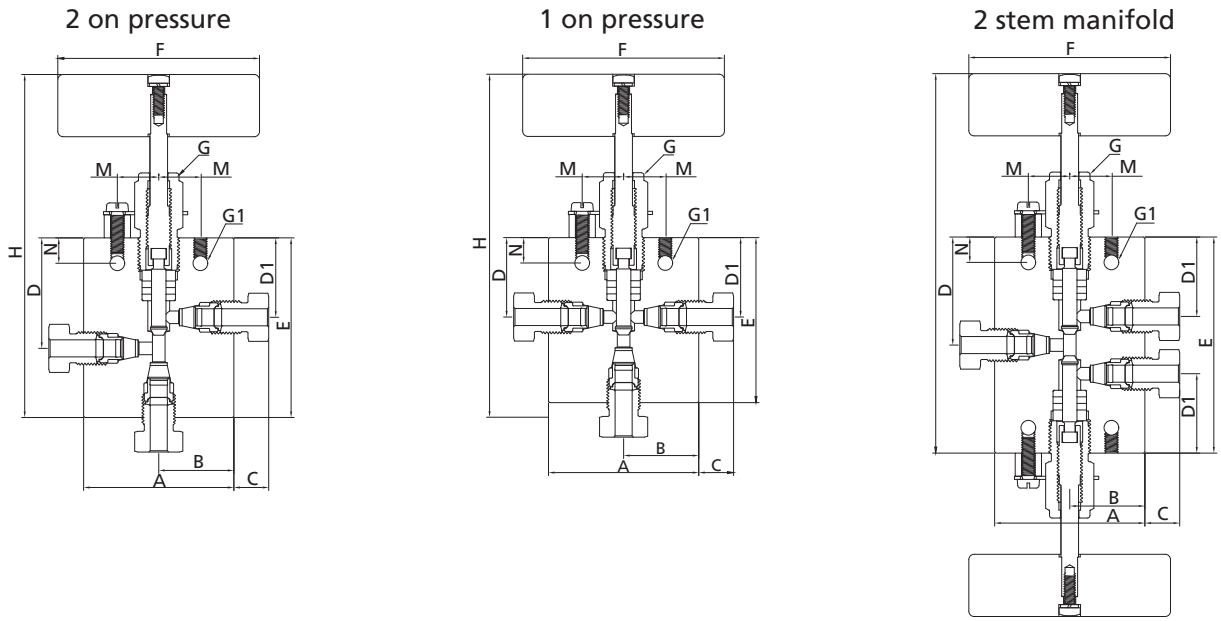

2 on pressure															
Ordering Number	Connection	Orifice in. (mm)	Dimensions, in. (mm)												
			A	B	C	D	D1	E	F	G	G1	H	M	N	Thickness
15NSS-DHL2-4	DHL2	0.094 (2.39)	1.81 (46.1)	0.91 (23.1)	0.44 (11.2)	1.06 (26.9)	0.81 (20.6)	1.85 (46.9)	1.75 (44.5)	0.62 (15.8)	0.17 (4.3)	3.45 (87.5)	0.56 (14.2)	0.31 (7.9)	0.62 (15.8)
15NSS-DHL4-4	DHL4	0.188 (4.77)	2.33 (59.2)	1.17 (29.6)	0.52 (13.3)	1.62 (41.2)	1.19 (30.2)	2.79 (70.8)	3.00 (76.2)	0.75 (19.1)	0.22 (5.6)	5.52 (140.3)	0.62 (15.8)	0.38 (9.7)	0.75 (19.1)
15NSS-DHL6-4	DHL6	0.250 (6.35)	2.27 (57.6)	1.13 (28.8)	0.54 (13.6)	1.62 (41.2)	1.19 (30.2)	2.76 (70.0)	3.00 (76.2)	0.75 (19.1)	0.22 (5.6)	5.59 (142.1)	0.62 (15.8)	0.38 (9.7)	0.75 (19.1)
15NSS-DHL8-4	DHL8	0.375 (9.53)	2.86 (72.7)	1.43 (36.4)	0.60 (15.3)	2.38 (60.5)	1.75 (44.5)	3.80 (96.6)	4.00 (101.6)	1.00 (25.4)	0.34 (8.6)	6.96 (176.7)	0.69 (17.5)	0.50 (12.7)	1.00 (25.4)

1 on pressure															
Ordering Number	Connection	Orifice in. (mm)	Dimensions, in. (mm)												
			A	B	C	D	D1	E	F	G	G1	H	M	N	Thickness
15NSS-DHL2-5	DHL2	0.094 (2.39)	1.81 (46.1)	0.91 (23.1)	0.44 (11.2)	0.81 (20.6)	1.56 (39.6)	1.75 (44.5)	0.62 (15.8)	0.17 (4.3)	3.32 (84.3)	0.56 (14.2)	0.31 (7.9)	0.62 (15.8)	
15NSS-DHL4-5	DHL4	0.188 (4.77)	2.33 (59.2)	1.17 (29.6)	0.52 (13.3)	1.19 (30.2)	2.43 (61.7)	3.00 (76.2)	0.75 (19.1)	0.22 (5.6)	5.33 (135.4)	0.62 (15.8)	0.38 (9.7)	0.75 (19.1)	
15NSS-DHL6-5	DHL6	0.250 (6.35)	2.27 (57.6)	1.13 (28.8)	0.54 (13.6)	1.19 (30.2)	2.43 (61.7)	3.00 (76.2)	0.75 (19.1)	0.22 (5.6)	5.40 (137.2)	0.62 (15.8)	0.38 (9.7)	0.75 (19.1)	
15NSS-DHL8-5	DHL8	0.375 (9.53)	2.86 (72.7)	1.43 (36.4)	0.60 (15.3)	1.75 (44.5)	3.38 (85.9)	4.00 (101.6)	1.00 (25.4)	0.34 (8.6)	6.71 (170.4)	0.69 (17.5)	0.50 (12.7)	1.00 (25.4)	

2 stem manifold															
Ordering Number	Connection	Orifice in. (mm)	Dimensions, in. (mm)												
			A	B	C	D	D1	E	F	G	G1	H	M	N	Thickness
15NSS-DHL2-6	DHL2	0.094 (2.39)	1.81 (46.1)	0.91 (23.1)	0.44 (11.2)	1.12 (28.5)	0.81 (20.6)	2.25 (57.2)	1.75 (44.5)	0.62 (15.8)	0.17 (4.3)	4.00 (101.8)	0.56 (14.2)	0.31 (7.9)	0.62 (15.8)
15NSS-DHL4-6	DHL4	0.188 (4.77)	2.33 (59.2)	1.17 (29.6)	0.52 (13.3)	1.69 (42.9)	1.19 (30.2)	3.38 (85.9)	3.00 (76.2)	0.75 (19.1)	0.22 (5.6)	6.28 (159.6)	0.62 (15.8)	0.38 (9.7)	0.75 (19.1)
15NSS-DHL6-6	DHL6	0.250 (6.35)	2.27 (57.6)	1.13 (28.8)	0.54 (13.6)	1.69 (42.9)	1.19 (30.2)	3.38 (85.9)	3.00 (76.2)	0.75 (19.1)	0.22 (5.6)	6.35 (161.3)	0.62 (15.8)	0.38 (9.7)	0.75 (19.1)
15NSS-DHL8-6	DHL8	0.375 (9.53)	2.86 (72.7)	1.43 (36.4)	0.60 (15.3)	2.56 (65.0)	1.75 (44.5)	5.12 (130.1)	4.00 (101.6)	1.00 (25.4)	0.34 (8.6)	8.45 (214.7)	0.69 (17.5)	0.50 (12.7)	1.00 (25.4)

Medium & High Pressure Fittings and Tubing

Quick Couplings

Medium & High Pressure Valves

Line Filters

Sour Service Products

Subsea Valves

Tools and Installation Instructions

Technical Information

Ordering Information and Dimensions (Pipe Connection, 2-Way)

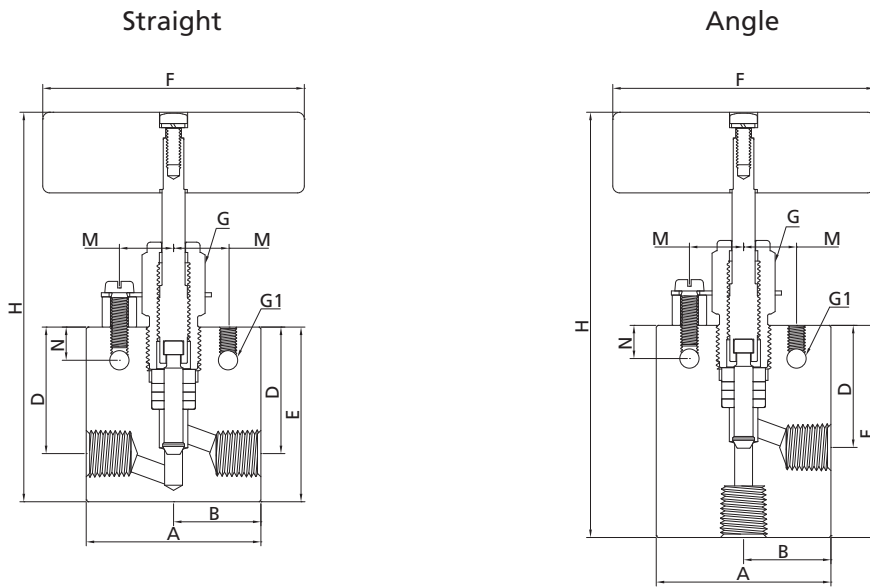

Straight															
Ordering Number	Connection	Orifice in. (mm)	Dimensions, in. (mm)												
			A	B	C	D	D1	E	F	G	G1	H	M	N	Thickness
15NSS-FNS2-1	FNS2	0.078 (1.98)	1.50 (38.1)	0.75 (19.1)	/	0.82 (20.6)	/	1.25 (31.8)	1.75 (44.5)	0.62 (15.8)	0.17 (4.3)	3.00 (76.4)	0.56 (14.2)	0.31 (7.9)	0.63 (15.9)
15NSS-FRT2-1	FRT2														
15NSS-FNS4-1	FNS4	0.203 (5.2)	2.00 (50.8)	1.00 (25.4)	/	1.41 (35.8)	/	2.00 (50.8)	3.00 (76.2)	0.75 (19.1)	0.22 (5.6)	4.89 (124.1)	0.62 (15.8)	0.38 (9.7)	0.75 (19.1)
15NSS-FRT4-1	FRT4														
15NSS-FNS6-1	FNS6	0.219 (5.56)	2.50 (63.5)	1.25 (31.8)	/	1.41 (35.8)	/	2.00 (50.8)	3.00 (76.2)	0.75 (19.1)	0.22 (5.6)	4.85 (123.1)	0.62 (15.8)	0.38 (9.7)	1.00 (25.4)
15NSS-FRT6-1	FRT6														
15NSS-FNS8-1	FNS8	0.312 (7.92)	3.00 (76.2)	1.50 (38.1)	/	2.06 (52.3)	/	2.88 (73.2)	4.00 (101.6)	1.00 (25.4)	0.34 (8.6)	6.18 (157.2)	0.69 (17.5)	0.50 (12.7)	1.38 (35.1)
15NSS-FRT8-1	FRT8														

Angle															
Ordering Number	Connection	Orifice in. (mm)	Dimensions, in. (mm)												
			A	B	C	D	D1	E	F	G	G1	H	M	N	Thickness
15NSS-FNS2-2	FNS2	0.078 (1.98)	1.50 (38.1)	0.75 (19.1)	/	0.81 (20.6)	/	1.38 (34.9)	1.75 (44.5)	0.62 (15.8)	0.17 (4.3)	3.13 (79.5)	0.56 (14.2)	0.31 (7.9)	0.63 (15.9)
15NSS-FRT2-2	FRT2														
15NSS-FNS4-2	FNS4	0.203 (5.2)	2.00 (50.8)	1.00 (25.4)	/	1.41 (35.8)	/	2.44 (62.0)	3.00 (76.2)	0.75 (19.1)	0.22 (5.6)	5.33 (135.4)	0.62 (15.8)	0.38 (9.7)	0.75 (19.1)
15NSS-FRT4-2	FRT4														
15NSS-FNS6-2	FNS6	0.219 (5.56)	2.50 (63.5)	1.25 (31.8)	/	1.41 (35.8)	/	2.44 (62.0)	3.00 (76.2)	0.75 (19.1)	0.22 (5.6)	5.34 (135.7)	0.62 (15.8)	0.38 (9.7)	1.00 (25.4)
15NSS-FRT6-2	FRT6														
15NSS-FNS8-2	FNS8	0.312 (7.92)	3.00 (76.2)	1.50 (38.1)	/	2.06 (52.3)	/	3.38 (85.9)	4.00 (101.6)	1.00 (25.4)	0.34 (8.6)	6.69 (169.9)	0.69 (17.5)	0.50 (12.7)	1.38 (35.1)
15NSS-FRT8-2	FRT8														

Medium & High Pressure Fittings and Tubing

Quick Couplings

Medium & High Pressure Valves

Line Filters

Sour Service Products

Subsea Valves

Tools and Installation Instructions

Technical Information

Ordering Information and Dimensions (Pipe Connection, 3-Way)

2 on pressure

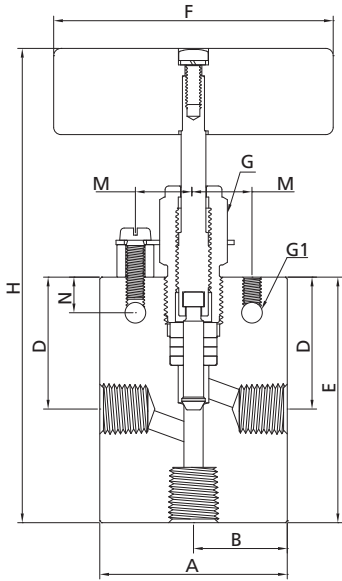

1 on pressure

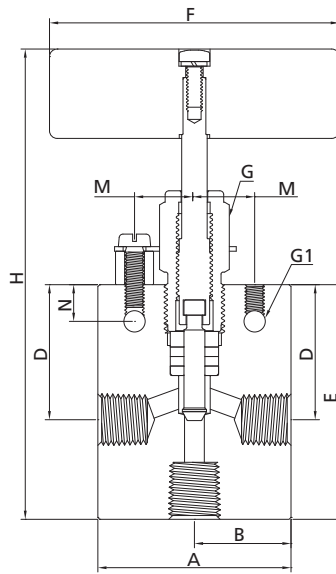

2 stem manifold

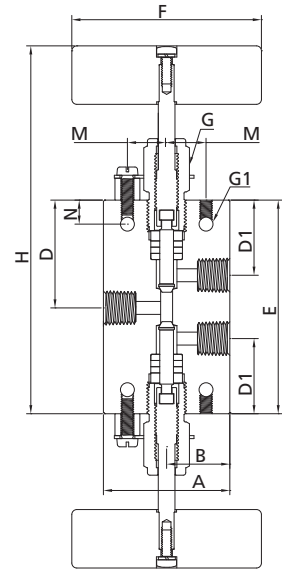

2 on pressure

Ordering Number	Connection	Orifice in. (mm)	Dimensions, in. (mm)												
			A	B	C	D	D1	E	F	G	G1	H	M	N	Thickness
15NSS-FNS2-4	FNS2	0.078 (1.98)	1.50 (38.1)	0.75 (19.1)	/	0.82 (20.6)	/	1.57 (40.0)	1.75 (44.5)	0.62 (15.8)	0.17 (4.3)	3.33 (84.6)	0.56 (14.2)	0.31 (7.9)	0.63 (15.9)
15NSS-FRT2-4	FRT2														
15NSS-FNS4-4	FNS4	0.203 (5.2)	2.00 (50.8)	1.00 (25.4)	/	1.41 (35.8)	/	2.62 (66.6)	3.00 (76.2)	0.75 (19.1)	0.22 (5.6)	5.51 (140.0)	0.62 (15.8)	0.38 (9.7)	0.75 (19.1)
15NSS-FRT4-4	FRT4														
15NSS-FNS6-4	FNS6	0.219 (5.56)	2.50 (63.5)	1.25 (31.8)	/	1.41 (35.8)	/	2.62 (66.6)	3.00 (76.2)	0.75 (19.1)	0.22 (5.6)	5.47 (138.9)	0.62 (15.8)	0.38 (9.7)	1.00 (25.4)
15NSS-FRT6-4	FRT6														
15NSS-FNS8-4	FNS8	0.312 (7.92)	3.00 (76.2)	1.50 (38.1)	/	2.06 (52.3)	/	3.62 (92.0)	4.00 (101.6)	1.00 (25.4)	0.34 (8.6)	6.94 (176.26)	0.69 (17.5)	0.50 (12.7)	1.38 (35.1)
15NSS-FRT8-4	FRT8														

1 on pressure

Ordering Number	Connection	Orifice in. (mm)	Dimensions, in. (mm)												
			A	B	C	D	D1	E	F	G	G1	H	M	N	Thickness
15NSS-FNS2-5	FNS2	0.078 (1.98)	1.50 (38.1)	0.75 (19.1)	/	0.82 (20.6)	/	1.38 (35.0)	1.75 (44.5)	0.62 (15.8)	0.17 (4.3)	3.13 (79.5)	0.56 (14.2)	0.31 (7.9)	0.63 (15.9)
15NSS-FRT2-5	FRT2														
15NSS-FNS4-5	FNS4	0.203 (5.2)	2.00 (50.8)	1.00 (25.4)	/	1.41 (35.8)	/	2.44 (62.0)	3.00 (76.2)	0.75 (19.1)	0.22 (5.6)	5.33 (135.4)	0.62 (15.8)	0.38 (9.7)	0.75 (19.1)
15NSS-FRT4-5	FRT4														
15NSS-FNS6-5	FNS6	0.219 (5.56)	2.50 (63.5)	1.25 (31.8)	/	1.41 (35.8)	/	2.44 (62.0)	3.00 (76.2)	0.75 (19.1)	0.22 (5.6)	5.34 (135.7)	0.62 (15.8)	0.38 (9.7)	1.00 (25.4)
15NSS-FRT6-5	FRT6														
15NSS-FNS8-5	FNS8	0.312 (7.92)	3.00 (76.2)	1.50 (38.1)	/	2.06 (52.3)	/	3.38 (85.9)	4.00 (101.6)	1.00 (25.4)	0.34 (8.6)	6.69 (169.9)	0.69 (17.5)	0.50 (12.7)	1.38 (35.1)
15NSS-FRT8-5	FRT8														

Medium & High Pressure Fittings and Tubing

Quick Couplings

Medium & High Pressure Valves

Line Filters

Sour Service Products

Subsea Valves

Tools and Installation Instructions

Technical Information

C-25 Needle Valves and Pneumatic Needle Valves

2 stem manifold															
Ordering Number	Connection	Orifice in. (mm)	Dimensions, in. (mm)												
			A	B	C	D	D1	E	F	G	G1	H	M	N	Thickness
15NSS-FNS2-6	FNS2	0.078 (1.98)	1.50 (38.1)	0.75 (19.1)	/	1.00 (25.6)	0.68 (17.2)	2.02 (51.2)	1.75 (44.5)	0.62 (15.8)	0.17 (4.3)	3.77 (95.8)	0.56 (14.2)	0.31 (7.9)	0.63 (15.9)
15NSS-FRT2-6	FRT2														
15NSS-FNS4-6	FNS4	0.203 (5.2)	2.00 (50.8)	1.00 (25.4)	/	1.69 (42.9)	1.19 (30.2)	3.38 (85.9)	3.00 (76.2)	0.75 (19.1)	0.22 (5.6)	6.27 (159.2)	0.62 (15.8)	0.38 (9.7)	0.75 (19.1)
15NSS-FRT4-6	FRT4														
15NSS-FNS6-6	FNS6	0.219 (5.56)	2.50 (63.5)	1.25 (31.8)	/	1.69 (42.9)	1.19 (30.2)	3.38 (85.9)	3.00 (76.2)	0.75 (19.1)	0.22 (5.6)	6.22 (158.1)	0.62 (15.8)	0.38 (9.7)	1.00 (25.4)
15NSS-FRT6-6	FRT6														
15NSS-FNS8-6	FNS8	0.312 (7.92)	3.00 (76.2)	1.50 (38.1)	/	2.56 (65.1)	1.75 (44.5)	5.12 (130.1)	4.00 (101.6)	1.00 (25.4)	0.34 (8.6)	8.43 (214.2)	0.69 (17.5)	0.50 (12.7)	1.38 (35.1)
15NSS-FRT8-6	FRT8														

NOTES: 1. G is the drill dimension of packing gland mounting hole.

2. G1 is the dimension of bracket mounting hole.

3. Panel mounting drill size: 0.25" all valves.

4. H is the dimension of stem in closed position.

5. All dimensions for reference only and subject to change. For dimensions not shown above, please contact the FITOK Group or our authorized distributors.

Medium & High Pressure Fittings and Tubing
Quick Couplings
Medium & High Pressure Valves
Line Filters
Sour Service Products
Subsea Valves
Tools and Installation Instructions
Technical Information