

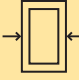

## SV6Y – Two way straight valves



High Pressure (H.P.) – 30,000 psi

#		Orifice					
		mm	inch	mm	inch	MPa	psi
SV6Y-4C-30	1/4" H.P.	2.3	0.09	25.4	1.00	206.8	30,000
SV6Y-6C-30	3/8" H.P.	3.0	0.12	25.4	1.00	206.8	30,000
SV6Y-9C-30	9/16" H.P.	3.0	0.12	38.1	1.50	206.8	30,000

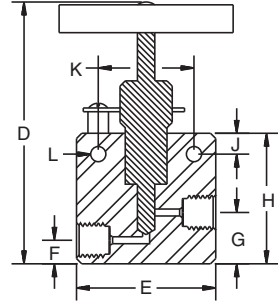

#	D		E		F		G		H		J		K		L	
	mm	inch	mm	inch	mm	inch	mm	inch	mm	inch	mm	inch	mm	inch	mm	inch
SV6Y-4C-30	131.6	5.18	50.8	2.00	15.7	0.62	25.4	1.00	61.7	2.43	12.7	0.50	34.8	1.37	5.3	0.21
SV6Y-6C-30	131.6	5.18	50.8	2.00	15.7	0.62	25.4	1.00	61.7	2.43	12.7	0.50	34.8	1.37	5.3	0.21
SV6Y-9C-30	142.7	5.62	66.5	2.62	25.4	1.00	36.3	1.43	72.9	2.87	12.7	0.50	34.8	1.37	5.3	0.21

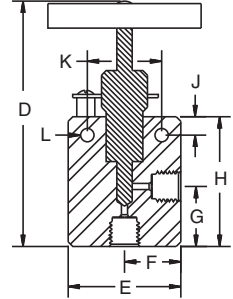

**AV6Y – Two way angle valves**  
High Pressure (H.P.) – 30,000 psi

#		Orifice					
		mm	inch	mm	inch	MPa	psi
AV6Y-4C-30	1/4" H.P.	2.3	0.09	25.4	1.00	206.8	30,000
AV6Y-6C-30	3/8" H.P.	3.0	0.12	25.4	1.00	206.8	30,000
AV6Y-9C-30	9/16" H.P.	3.0	0.12	38.1	1.50	206.8	30,000



#	D		E		F		G		H		J		K		L	
	mm	inch	mm	inch	mm	inch	mm	inch	mm	inch	mm	inch	mm	inch	mm	inch
AV6Y-4C-30	131.6	5.18	50.8	2.00	25.4	1.00	25.4	1.00	61.7	2.43	12.7	0.50	34.8	1.37	5.3	0.21
AV6Y-6C-30	141.2	5.56	50.8	2.00	25.4	1.00	34.8	1.37	71.4	2.81	12.7	0.50	34.8	1.37	5.3	0.21
AV6Y-9C-30	142.7	5.62	66.5	2.62	33.3	1.31	36.3	1.43	72.9	2.87	12.7	0.50	34.8	1.37	5.3	0.21

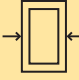

**TV26Y – Three way valves**  
 High Pressure (H.P.) – 30,000 psi  
 Two pressure connections

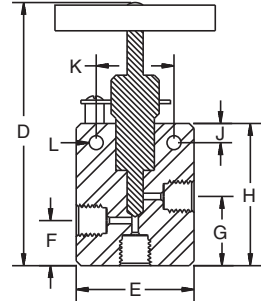
#		Orifice					
		mm	inch	mm	inch	MPa	psi
TV26Y-4C-30	1/4" H.P.	2.3	0.09	25.4	1.00	206.8	30,000
TV26Y-6C-30	3/8" H.P.	3.0	0.12	25.4	1.00	206.8	30,000
TV26Y-9C-30	9/16" H.P.	3.0	0.12	38.1	1.50	206.8	30,000



#	D		E		F		G		H		J		K		L	
	mm	inch	mm	inch	mm	inch	mm	inch	mm	inch	mm	inch	mm	inch	mm	inch
TV26Y-4C-30	131.6	5.18	50.8	2.00	15.7	0.62	25.4	1.00	61.7	2.43	12.7	0.50	34.8	1.37	5.3	0.21
TV26Y-6C-30	141.2	5.56	50.8	2.00	25.4	1.00	34.8	1.37	71.4	2.81	12.7	0.50	34.8	1.37	5.3	0.21
TV26Y-9C-30	153.9	6.06	66.5	2.62	36.3	1.43	47.5	1.87	84.1	3.31	12.7	0.50	34.8	1.37	5.3	0.21

**TV16Y – Three way valves**  
**High Pressure (H.P.) – 30,000 psi**  
**One pressure connection**

#		Orifice					
		mm	inch	mm	inch	MPa	psi
TV16Y-4C-30	1/4" H.P.	2.3	0.09	25.4	1.00	206.8	30,000
TV16Y-6C-30	3/8" H.P.	3.0	0.12	25.4	1.00	206.8	30,000
TV16Y-9C-30	9/16" H.P.	3.0	0.12	38.1	1.50	206.8	30,000

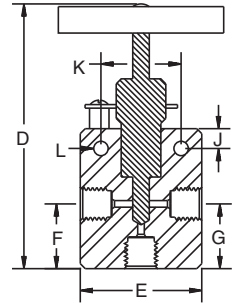

#	D		E		F		G		H		J		K		L	
	mm	inch	mm	inch	mm	inch	mm	inch	mm	inch	mm	inch	mm	inch	mm	inch
TV16Y-4C-30	131.6	5.18	50.8	2.00	25.4	1.00	25.4	1.00	61.7	2.43	12.7	0.50	34.8	1.37	5.3	0.21
TV16Y-6C-30	141.2	5.56	50.8	2.00	50.8	2.00	36.3	1.43	71.4	2.81	12.7	0.50	34.8	1.37	5.3	0.21
TV16Y-9C-30	142.7	5.62	66.5	2.62	55.4	2.18	36.3	1.43	72.9	2.87	12.7	0.50	34.8	1.37	5.3	0.21