

# MEDIUM PRESSURE EQUIPMENT

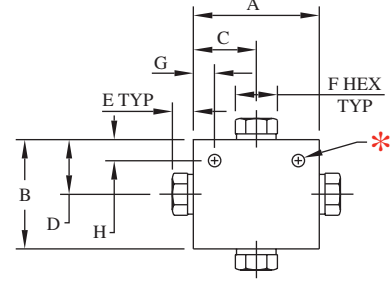
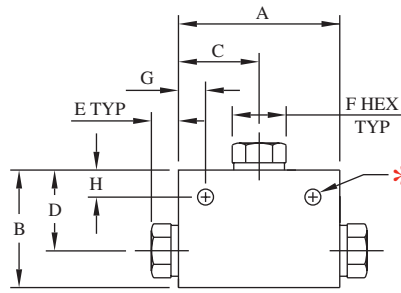
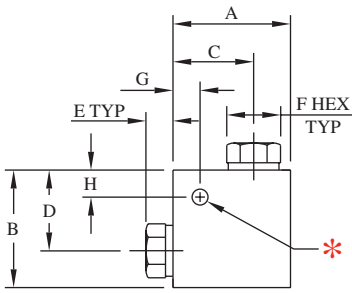

## ELBOWS

Catalog Number	Connection	Port	MAWP	A	B	C	D	E	F	Block Thickness	Mounting Holes*		
											G	H	Dia.
20L4	1/4" M/P Tube	0.125" (3.2)	20,000 PSI 1380 bar	1.50" (38.1)	1.13" (28.7)	0.75" (19.1)	0.75" (19.1)	0.35" (8.9)	0.50" (12.7)	0.62" (15.7)	0.25" (6.4)	0.25" (6.4)	0.22" (5.6)
20L6	3/8" M/P Tube	0.203" (5.2)	20,000 PSI 1380 bar	2.00" (50.8)	1.38" (35.1)	1.00" (25.4)	1.00" (25.4)	0.47" (11.9)	0.63" (16.0)	0.75" (19.1)	0.31" (7.9)	0.31" (7.9)	0.22" (5.6)
20L9	9/16" M/P Tube	0.359" (9.1)	20,000 PSI 1380 bar	2.50" (63.5)	1.75" (44.5)	1.25" (31.8)	1.25" (31.8)	0.66" (16.8)	0.88" (22.4)	1.00" (25.4)	0.50" (12.7)	0.50" (12.7)	0.28" (7.1)
20L12	3/4" M/P Tube	0.515" (13.1)	20,000 PSI 1380 bar	3.00" (76.2)	2.25" (57.2)	1.50" (38.1)	1.50" (38.1)	0.55" (14.0)	1.18" (30.0)	1.38" (35.1)	0.50" (12.7)	0.50" (12.7)	0.34" (8.7)
20L16	1" M/P Tube	0.562" (14.3)	20,000 PSI 1380 bar	4.12" (104.6)	3.00" (76.2)	2.06" (52.3)	2.06" (52.3)	0.69" (17.5)	1.38" (35.1)	1.75" (44.5)	0.69" (17.5)	0.69" (17.5)	0.41" (10.4)

## TEES

Catalog Number	Connection	Port	MAWP	A	B	C	D	E	F	Block Thickness	Mounting Holes*		
											G	H	Dia.
20T4	1/4" M/P Tube	0.109" (2.8)	20,000 PSI 1380 bar	1.50" (38.1)	1.13" (28.7)	0.75" (19.1)	0.75" (19.1)	0.35" (8.9)	0.50" (12.7)	0.62" (15.7)	0.25" (6.4)	0.25" (6.4)	0.22" (5.6)
20T6	3/8" M/P Tube	0.203" (5.2)	20,000 PSI 1380 bar	2.00" (50.8)	1.38" (35.1)	1.00" (25.4)	1.00" (25.4)	0.47" (11.9)	0.63" (16.0)	0.75" (19.1)	0.31" (7.9)	0.31" (7.9)	0.22" (5.6)
20T9	9/16" M/P Tube	0.359" (9.1)	20,000 PSI 1380 bar	2.50" (63.5)	1.75" (44.5)	1.25" (31.8)	1.25" (31.8)	0.66" (16.8)	0.88" (22.4)	1.00" (25.4)	0.50" (12.7)	0.50" (12.7)	0.28" (7.1)
20T12	3/4" M/P Tube	0.515" (13.1)	20,000 PSI 1380 bar	3.00" (76.2)	2.25" (57.2)	1.50" (38.1)	1.50" (38.1)	0.55" (14.0)	1.18" (30.0)	1.38" (35.1)	0.50" (12.7)	0.50" (12.7)	0.34" (8.6)
20T16	1" M/P Tube	0.562" (14.3)	20,000 PSI 1380 bar	4.12" (104.6)	3.00" (76.2)	2.06" (52.3)	2.06" (52.3)	0.69" (17.5)	1.38" (35.1)	1.75" (44.5)	0.69" (17.5)	0.69" (17.5)	0.41" (10.4)

## CROSSES

Catalog Number	Connection	Port	MAWP	A	B	C	D	E	F	Block Thickness	Mounting Holes*		
											G	H	Dia.
20X4	1/4" M/P Tube	0.125" (3.2)	20,000 PSI 1380 bar	1.50" (38.1)	1.50" (38.1)	0.75" (19.1)	0.75" (19.1)	0.35" (8.9)	0.50" (12.7)	0.62" (15.7)	0.25" (6.4)	0.25" (6.4)	0.22" (5.6)
20X6	3/8" M/P Tube	0.203" (5.2)	20,000 PSI 1380 bar	2.00" (50.8)	2.00" (50.8)	1.00" (25.4)	1.00" (25.4)	0.47" (11.9)	0.63" (16.0)	0.75" (19.1)	0.38" (9.7)	0.38" (9.7)	0.25" (6.4)
20X9	9/16" M/P Tube	0.359" (9.1)	20,000 PSI 1380 bar	2.50" (63.5)	2.50" (63.5)	1.25" (31.8)	1.25" (31.8)	0.66" (16.8)	0.88" (22.4)	1.00" (25.4)	0.50" (12.7)	0.50" (12.7)	0.28" (7.1)
20X12	3/4" M/P Tube	0.515" (13.1)	20,000 PSI 1380 bar	3.00" (76.2)	3.00" (76.2)	1.50" (38.1)	1.50" (38.1)	0.55" (14.0)	1.18" (30.0)	1.38" (35.1)	0.50" (12.7)	0.50" (12.7)	0.34" (8.7)
20X16	1" M/P Tube	0.687" (17.4)	20,000 PSI 1380 bar	4.12" (104.6)	4.12" (104.6)	2.06" (52.3)	2.06" (52.3)	0.69" (17.5)	1.38" (35.1)	1.75" (44.5)	0.69" (17.5)	0.69" (17.5)	0.41" (10.3)

\*Mounting holes provided when the catalog number is suffixed by "-MH" when ordering.

All dimensions are for reference only and are subject to change.  
Dimensions in parentheses are millimeters (mm)

